



# WINDOW MANUFACTURING

PREMIUM SUPPLIER FOR WINDOW  
AND DOOR INDUSTRY



# ABOUT SOUDAL

## SOUDAL BUILD THE FUTURE

SOUDAL is Europe's leading independent manufacturer of adhesives, sealants and PU foams. This family-owned business with its headquarters in Turnhout, Belgium, was founded by Vic Swerts, in 1966. Nowadays, Soudal has become an international player and expert in chemical construction specialties. With more than 3500 employees worldwide and due to its continuous growth, improvements and innovations Soudal achieved a turnover of €911 million, in 2020.

Soudal has a long-term vision on innovation and wants to achieve this by focusing on R&D for the development of new and innovative solutions, and by continuously improving and optimizing existing products. The aim of Soudal is to supply innovative and high-quality products that meet the high demands and needs of end-users and the market.



### Internationalisation



73

Own affiliates



+3.600

People



140

Total countries

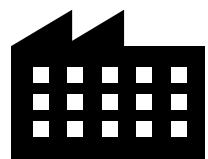

23

Production sites

# RELIABLE PARTNER

Soudal has been a reliable partner for decades supplying the construction world and industry with reliable, innovative and up-to-date quality products that boast user-friendliness. Thanks to an international sales structure and an excellent market penetration, Soudal is able to supply these products swiftly to customers worldwide. Windows & Doors (Fenestration) have been a major focus of Soudal's dedicated marketing and sales team; manufacturers and installers alike are familiar with the Soudal brand and stick with it for window fabrication, installation and sealing. Soudal bundled all of its experience and knowledge together in 3 different window system solutions. These systems offer a complete range of products and solutions that match the industry's needs perfectly.



## **Soudal Window Manufacturing (SWM)**

Soudal Window Manufacturing is a system solution for window & door fabricators. With SWM, Soudal offers a wide and complete range of products for the window and door industry. The range includes products for the production of double glass, the fabrication of windows and doors, to the installation and durable airtight finishing in the construction site.



## **Soudal Window Installation (SWI)**

SoudaFrame SWI is an intelligent modular pre-frame system for the installation of exterior joinery, made from glass fibre reinforced plastic (GFRP). This Passive House certified system ensures a thermally optimal window installation, without thermal bridges. The system can be used universally for new builds and renovations and is available in various sizes.



## **Soudal Window System (SWS)**

Soudal Window System offers a solution for the increasingly stringent expectations and requirements regarding the energy performance of buildings, by combining (certified) high-quality products for a long-lasting, well insulated, airtight and weatherproof seal around window & door connections. Through its diversity in products (sealants, PU-foams, pre-compressed tapes, (liquid) membranes and self-adhesive tapes) SWS can always offer the right combination and solution regardless of the building or installation method!



# SOUDAL



## SOUDAL WINDOW MANUFACTURING

## ONE-STOP SUPPLIER FOR THE WINDOW INDUSTRY

With SWM (Soudal Window Manufacturing), Soudal offers a wide and complete range of products for the window & door industry. These products range from the production of double glass and the fabrication of windows and doors in fabrics, to the installation and durable airtight finishing on the construction site.

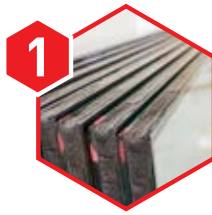

**PRODUCTION OF IGU SEALANTS**



**INSULATION OF WINDOW FRAMES**

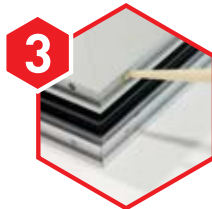

**WINDOW FABRICATION**



**WINDOW INSTALLATION**



**WINDOW SEALING**

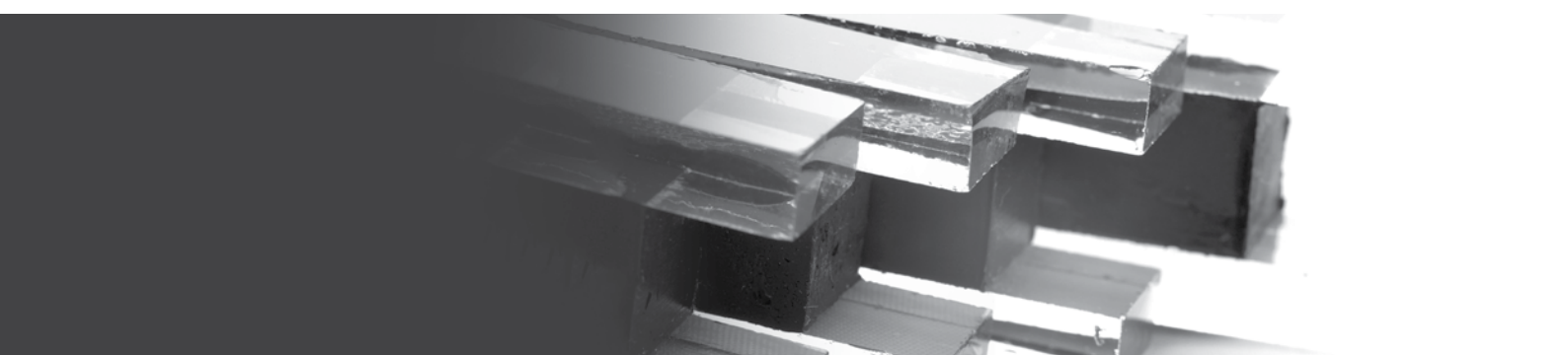

# ONE-STOP SUPPLIER FOR WINDOW FABRICATORS



MEMBER OF THE **SOUDAL** GROUP

## TENACHEM

TenaChem is the largest manufacturer of construction chemistry in the Baltic States and one of the leading suppliers of sealants for the glass industry in Europe. In 2015, it has become part of the Soudal Group. TenaChem produces inner and outer sealants for the manufacturing (bonding) of IGU (Insulated Glass Unit). Over the years the company has continuously worked on the diversity of its product range and on increasing its production quantities, observing the highest requirements of manufacturing quality.

### Products:

TENABOND® range of adhesives based on MS Polymer® technology for IGU bonding, TENAGLASS® range of two component (polyurethane or polysulphide) outer sealants for the production of IGU with dual seal and Tenasol a cleaning agent for dispensing systems in IGU production.



MEMBER OF THE **SOUDAL** GROUP

## SAPAC

Sapac is a Belgian system supplier and manufacturer of foam machines for the packaging and insulation market. It has become a member of the Soudal Group in 2016. With its patented technology, Sapac has been offering its customers a flexible, safe and maintenance-friendly way of packaging and insulating. Sapac is the market leader for 2-component foam machines with fully closed exchangeable bottles. Sapac offers the customer a solution from A to Z, from installation and maintenance of the machines, development and production of the right foams, to collection of the empty bottles.

### Machine:

Sapac M-01 is a PU-foam injection system for the thermal insulation and structural enhancement of windows and window profiles. The pre-programmable machine with a touchscreen display can be used with Soudafoam MAXTWO HFO (or as an alternative Soudafoam PPF-3531).



**SOUDAL  
WINDOW  
MANUFACTURING**

# PRODUCT OVERVIEW:

## 1. PREPARATION

SURFACE ACTIVATOR .....	PG 9
ACTIVATOR SPRAY 601 .....	PG 9

## 2. CORROSION PROTECTION - WATERPROOFING

ALUSEAL .....	PG 10
ALUSEAL HYBRID .....	PG 10

## 3. SURFACE CLEANERS

SURFACE CLEANER .....	PG 11
ADHESIVE REMOVER CT .....	PG 11

## 4. ALUMINIUM BONDING

SOUDABOND 641 .....	PG 13
SOUDABOND 642 DUO .....	PG 14

## 5. WOOD BONDING

HB CONSTRUCT .....	PG 16
PRO 40PA .....	PG 16
PRO 45P .....	PG 17

## 6. REBATE FILLING

SOUDATHERM SFI 600P .....	PG 19
---------------------------	-------

## 7. GENERAL PURPOSE BONDING

SOUDASEAL 2K .....	PG 20
SOUDASEAL 650 HT .....	PG 21
MITRE KIT .....	PG 21

## 8. MAINTENANCE

PVCU FRAME CLEANER .....	PG 22
PVCU CREAM CLEANER .....	PG 22
GLASS & MIRROR CLEANER .....	PG 23

## 9. ACCESSORIES

SILICONE SPRAY .....	PG 24
PTFE SPRAY .....	PG 24
MULTI SPRAY .....	PG 25
CLEANER & DEGREASER .....	PG 25
DEGRIP ALL .....	PG 26
MULTI CLEANER FOAM .....	PG 26
PE GLAZING TAPE .....	PG 27
DOUBLE-SIDED TRANSPARENT TAPE .....	PG 27



# 1. PREPARATION

## SURFACE ACTIVATOR

### DESCRIPTION

Surface Activator is an adhesion promoter used for activating non-porous surfaces to achieve an improved adhesion. Cleaning and degreasing of non-porous substrates.

### PROPERTIES

- Liquid surface activator for non-porous surfaces
- Cleans, degreases and activates
- Universal use, can be used with many types of sealants and adhesives
- One component
- Easy to use

Product description	Colour	Packaging	Volume	Box	Pallet	Art. nr.
Surface Activator	Colourless	Canister	500 ml	6	900	101638
Surface Activator	Colourless	Canister	5 l	1	64	113596
Surface Activator	Colourless	Jerry Can	25 l	1	22	110372



## ACTIVATOR SPRAY 601

### DESCRIPTION

Activator Spray 601 is an adhesion promoter especially designed for powder coated aluminium, both regular as textured powder coatings. The product leaves a completely invisible layer on the surface to improve the adhesion of sealants and adhesives. It can be used with polyurethane, silicone and hybrid (MS) sealants and adhesives. Activator Spray 601 is ready to use in aerosol can form. Once completely dry (approx. 2 minutes), sealants and adhesives can be applied.

### PROPERTIES

- Improves adhesion of hybrid and silicone based adhesives, sealants and tapes
- Ready to use
- Fast drying process
- Low consumption
- Dries transparently (does not leave a white residue)
- Suitable for powder coated and anodised Aluminium profiles

Product description	Colour	Packaging	Volume	Box	Pallet	Art. nr.
Activator Spray 601	Colourless	Aerosol	500 ml	12	624	134507



## 2. CORROSION PROTECTION - WATERPROOFING

### ALUSEAL



#### DESCRIPTION

Joint sealant, based on synthetic rubber for the corrosion protection of cut edges of aluminium window profiles and permanent sealing of mitre cuts in aluminium windows profiles. Non-aggressive to lacquers or coatings used in the fabrication of windows. Crystal clear, highly elastic and water and UV resistant. Very long open time and compatible with window fabrication adhesives - Soudabond 641 and Soudabond 642.

#### PROPERTIES

- Protects against corrosion
- UV resistant, waterproof and resistant to weathering
- Very long open time
- Can be painted with most types of paint systems
- Applicable with manual- or pneumatic caulking gun
- Compatible with Tekna TK259 machine

Product description	Colour	Packaging	Volume	Box	Pallet	Art. nr.
AluSeal	Transparent	Cartridge	310 ml	12	1440	128138
AluSeal	Grey	Cartridge	310 ml	12	1440	153731
AluSeal	Black	Cartridge	310 ml	12	1440	153732

\*Available in larger packaging on request



### ALUSEAL HYBRID



#### DESCRIPTION

Hybrid polymer-based sealant for the corrosion protection of cut edges of aluminium window profiles and for a permanent sealing of mitre cuts and butt joints. Label-free, very elastic, UV and water resistant.

#### PROPERTIES

- Protects against corrosion
- UV resistant, waterproof and resistant to weathering
- Stays elastic after curing and very durable
- Easy to apply and tool
- Can be painted with most types of paint systems
- Solvent and isocyanate free
- EC-1 PLUS label: very low emission

Product description	Colour	Packaging	Volume	Box	Pallet	Art. nr.
AluSeal Hybrid	Grey	Cartridge	290 ml	12	1440	156246
AluSeal Hybrid	White	Cartridge	290 ml	12	1440	156247
AluSeal Hybrid	Black	Cartridge	290 ml	12	1440	156248

\*Available in larger packaging on request



#### APPLICATION VIDEO



## 3. SURFACE CLEANERS

### SURFACE CLEANER

#### DESCRIPTION

Surface Cleaner is a universal solvent cleaner designed for use prior to the application of Soudal window fabrication products. It can also be used for the removal of excess Aluseal, PU, silicone and hybrid polymers.

#### PROPERTIES

- Cleaner and degreaser for aluminium windows
- Can be used to remove excess product (before curing)
- Can be used with other non-porous surfaces

Product description	Colour	Packaging	Volume	Box	Pallet	Art. nr.
Surface Cleaner	Colourless	Canister	500 ml	6	900	107789



### ADHESIVE REMOVER CT

#### DESCRIPTION

Remover CT is a non-aggressive blend, based on natural dissolvent, suitable for the removal of fresh adhesive residues and most types of hardened contact adhesives. The highly effective cleaning solution does not contain any solvents, therefore ideal for use on delicate surfaces; however a compatibility test is recommended. Equipped with Soudal's patented Genius Gun applicator technology for ease of use and precise application. Remover CT provides a fresh citrus odour.

#### PROPERTIES

- Universal use
- Non-corrosive
- Fresh citrus odour
- Contains no solvent
- Cleans and removes

Product description	Colour	Packaging	Volume	Box	Pallet	Art. nr.
Adhesive remover CT	Transparent	Aerosol	500 ml	12	780	135010





## 4. ALUMINIUM BONDING

### SOUDABOND 641



#### DESCRIPTION

Soudabond 641 is a high strength 1-component PU assembly adhesive, suitable for the constructional bonding of Aluminium corner angles into cover-frame and wing-frame profiles. Can also be used for bonding of metals in other applications. Especially developed for pre-injection systems. The functional bonding strength is reached after 24h in normal conditions, full cure in 7 days.

#### PROPERTIES

- High bonding strength
- Excellent adhesion on Aluminium
- Long open time
- Moisture curing
- Good weather resistance
- Fast strength build up and very high final strength
- Suitable for pre-injection systems

Product description	Colour	Packaging	Packaging	Box	Pallet	Art. nr.
Soudabond 641	Beige	Cartridge	310 ml	12	1440	130848
Soudabond 641	Black	Cartridge	310 ml	12	1440	131494

\*Available in foil packs on request



## 4. ALUMINIUM BONDING

### SOUDABOND 642 DUO



#### DESCRIPTION

Soudabond 642 Duo is a high strength 2-component PU assembly adhesive, suitable for the constructional bonding of Aluminium corner angles into cover-frame and wing-frame profiles. Can also be used for bonding of metals in other applications. Suitable for pre- and post-injection systems. Always use in combination with supplied static mixer. Before use, extrude the first 20 g to assure a homogenous mixing of the two components. Functional bonding strength: 5-10h in normal conditions.

#### PROPERTIES

- ☐ Very high bonding strength
- ☐ Fast curing, independent of moisture
- ☐ Very fast strength build-up and very high final strength
- ☐ Good weather resistance
- ☐ Solvent free
- ☐ 100% solids content, no shrinkage
- ☐ Foaming penetration action to fill bond cavities
- ☐ Universal application

#### APPLICATION VIDEO



Product description	Colour	Packaging	Volume	Box	Pallet	Art. nr.
Soudabond 642 Duo cartridge	Beige	Cartridge	2x300 ml	12	720	152623
Soudabond 642 Duo cartridge	Black	Cartridge	2x300 ml	12	720	154002

\*Available in larger packaging on request

### PNEUMATIC GUN 2K 1:1 CARTRIDGE

#### DESCRIPTION

Pneumatic gun for Soudabond 642 Duo in cartridges.

Article number: 152561



### MANUEL GUN 2K 1:1 CARTRIDGE

#### DESCRIPTION

Professional grade, heavy duty steel application gun to use with Soudabond 642 DUO and any other similar two-component, side-by-side cartridge packaging. Ratio 1:1.

Article number: 128708



## 4. ALUMINIUM BONDING

### SOUDABOND 642 DUO FOIL PACK



AVAILABLE IN FOIL PACK

NEW

#### BENEFITS:

- Longer shelf life of at least 18 months
- Two colors beige and black
- Improved extrudability
- More durable, reduces waste  
(environmental impact: 1 cartridge = 10 foil packs)



Product description	Colour	Packaging	Volume	Box	Pallet	Art. nr.
Soudabond 642 Duo foil pack	Beige	Foil pack	2x300 ml	10	660	152558
Soudabond 642 Duo foil pack	Black	Foil pack	2x300 ml	10	660	154001

### PNEUMATIC GUN 2K 1:1 FOIL PACK 2X300ML

#### DESCRIPTION

Pneumatic gun for Soudabond 642 Duo Foil Pack.

Article number: 152422



### END CAP FOIL PACK

#### DESCRIPTION

End cap for pneumatic gun Soudabond 642 Duo foil pack.

Article number: 336939



### CONNECTOR FOIL PACK

#### DESCRIPTION

Connector piece for pneumatic gun Soudabond 642 Duo foil pack.

Article number: 153575



### STATIC MIXER

#### DESCRIPTION

Static mixer to be used with Soudabond 642 Duo to generate the ideal mixing ratio. The tip can be cut to size depending on the application.

Article number: 128772



## 5. WOOD BONDING

### HB CONSTRUCT



#### DESCRIPTION

HB Construct is a unique waterproof (D4), nonfoaming, very strong, isocyanatefree construction adhesive based on SMX Polymer with excellent filling capacity.

#### PROPERTIES

- Water Resistant D4
- Isocyanate - & solvent free
- Non-foaming
- End-strength as high as PU based adhesives
- Handtight in 1hr
- High filling properties, up to 1mm
- No more after-clamping nor pressing
- Easy to finish without staining
- High Heat resistance

#### APPLICATION VIDEO



Product description	Colour	Packaging	Volume	Box	Pallet	Art. nr.
HB Construct	Brown	Cartridge	290 ml	15	1500	135782
HB Construct	Black	Cartridge	290 ml	15	1500	135783
HB Construct	White	Cartridge	290 ml	15	1500	135784

\*Available in larger volumes on request



### PRO 40P



#### DESCRIPTION

Professional quality, high strength and fast drying, PU liquid timber adhesive. Excellent water resistance: D4 (DIN EN 204). Easy application. Foaming penetration action to fill uneven surfaces. Can be used on damp/humid wood surfaces. 15 minute open time.

#### PROPERTIES

- Liquid PU adhesive
- Easy to tool
- Professional quality
- Foaming action to fill gaps
- Water resistant (D4)
- 15 minutes open time
- Pressing time: minimum 3 hours

Product description	Colour	Packaging	Volume	Box	Pallet	Art. nr.
PRO 40P	Brown	Bottle	750 g	6	630	108766
PRO 40P	Brown	Canister	5 kg	4	144	108901
PRO 40P	Brown	Jerry Can	20 kg	1	24	123155



## 5. WOOD BONDING

### PRO 45P



#### DESCRIPTION

Professional quality, high strength and ultra fast curing, PU liquid timber adhesive. Excellent water resistance: D4 (DIN EN 204). Easy application. Foaming action to fill uneven surfaces. Can be used on damp/humid wooden surfaces. 5 minute open time.

#### PROPERTIES

- Liquid PU adhesive
- Easy to tool
- Professional quality
- Foaming action to fill bond gaps
- Water resistant D4
- 5 minutes open time
- Pressing time: 30 minutes
- Ultra fast curing

Product description	Colour	Packaging	Volume	Box	Pallet	Art. nr.
PRO 45P	Brown	Bottle	750 g	6	630	108765
PRO 45P	Brown	Canister	5 kg	4	144	108902





## 6. REBATE FILLING

### SOUDATHERM SFI 600P

#### DESCRIPTION

Soudatherm SFI 600P is a polyurethane foam for the filling and sealing of cavities between the glass and frame of different types of windows and carpentry (rebate). Improves airtightness and Uf-values. Good adhesion on different types of materials such as PVC, Aluminium, wood and metals. Compatible with most IGU-sealants. Cavity must not be exposed to UV. Skin formation within 10 min, full cure after 24 hours. The foam can be applied efficiently and quickly with an adjustable gun system.

#### PROPERTIES

- Enhances the airtightness and acoustic insulation of windows
- Low thermal conductivity: 0.036 W/m.K
- Enhances mechanical stability
- Fast curing
- Easy, fast and professional application
- Controlled expansion rate|Low expansion
- Compatible with all type of window frame materials: aluminium, PVCu and wood and also IGU sealants
- Easy to cut in case glass has to be removed and/or replaced
- No flammable propellants

Product description	Colour	Packaging	Volume	Box	Pallet	Art. nr.
Soudatherm SFI 600P	Black	Pressurized Canister	10,4 kg	1	36	127997



#### APPLICATION VIDEO



### SOUDATHERM SFI 600P APPLICATOR

#### DESCRIPTION

Professional grade, ergonomical applicator gun with a double safety locking system and precise flow rate.

Article number: 128119



### CONICAL NOZZLE FOR SOUDATHERM SFI 600P

#### DESCRIPTION

Nozzle for Soudatherm SFI 600P to be mounted on the applicator gun. For easy application in narrow joints between the window pane and the frame of a window.

Article number: 128221 (per 50 pcs)



### REPLACEMENT HOSE FOR SOUDATHERM SFI 600P

#### DESCRIPTION

Replacement hose for professional applicator gun.

Article number: 200 cm: 123946  
 300 cm: 126888  
 500 cm: 127955



## 7. GENERAL PURPOSE BONDING

### SOUDASEAL 2K

#### DESCRIPTION

Super fast curing, two component, hybrid polymer sealant-adhesive. For use in elastical bonding applications where fast curing is required. Fast strength build-up. Fast curing. High performance mechanical properties. Permanently elastic after curing. Does not contain isocyanates, silicone and solvents. Cures without the presence of atmospheric moisture.

#### PROPERTIES

- Two component hybrid polymer sealant & adhesive
- Super fast cure speed
- Cures without atmospheric moisture
- Solvent, silicone and isocyanate free
- Static mixer also available

Product description	Colour	Packaging	Volume	Box	Pallet	Art. nr.
Soudaseal 2K	Grey	Cartridge	250 ml	6	810	119245
Mixers	-	-	10 pieces	-	-	119561

\*Available in larger packaging on request



## 7. GENERAL PURPOSE BONDING

### SOUDASEAL 650 HT



#### DESCRIPTION

Soudaseal 650 HT is a durable high-quality, neutral, elastic, 1-component adhesive based on SMX-Polymer with a very high initial tack. Good adhesion on slightly moist substrates.

#### PROPERTIES

- High initial tack
- Fast curing
- High shear strength
- Can be painted over
- Good weather and UV resistance
- Isocyanate and silicone free

Product description	Colour	Packaging	Volume	Box	Pallet	Art. nr.
Soudaseal 650 HT	White	Foil pack	600 ml	12	792	137106
Soudaseal 650 HT	Black	Foil pack	600 ml	12	792	146064
Soudaseal 650 HT	White	Bucket	20 l	1	16	146021
Soudaseal 650 HT	Black	Bucket	20 l	1	16	151949



### MITRE KIT

#### DESCRIPTION

Mitre Kit is a two-part instant adhesive system comprising a cyanoacrylate-based adhesive and an aerosol activator, which is particularly useful for production lines, PVCu window trim and EPDM gasket bonding. The super glue activator and super glue high viscosity are also separately available.

#### PROPERTIES

- Fast acting
- Fast curing
- Easy to use
- Activator reduces blooming and odour

Product description	Colour	Packaging	Volume	Box	Pallet	Art. nr.
Mitre Kit	Transparent	-	250 ml	30	960	154554



## 8. MAINTENANCE

### PVCU FRAME CLEANER

#### DESCRIPTION

Solvent based PVCu Frame Cleaner for PVCu materials. Specifically designed for removing most ingrained dirt, grease, uncured sealant, pencil and pen marks from white and foiled PVCu frames, sills, boards and panels and plastic garden furniture.

#### PROPERTIES

- Fast acting and drying
- Non-smearing
- Restores to a clear and shiny finish
- Perfumed
- Multi-purpose use
- Non-abrasive

Product description	Colour	Packaging	Volume	Box	Pallet	Art. nr.
PVCu Frame Cleaner	Colourless	Bottle	1 l	480	960	113621
PVC Spray Cleaner	Colourless	Aerosol	750 ml	12	672	156175



### PVCU CREAM CLEANER

#### DESCRIPTION

Solvent free PVCu Cream Cleaner for a sparkling finish on PVCu and other materials. Specifically designed for removing most ingrained dirt, grease, uncured sealant, pencil and pen marks from white and foiled PVCu frames, sills, boards and panels and plastic garden furniture. Environmentally friendly (very low VOC) and biodegradable. Can be buffed to a deep and attractive sheen.

#### PROPERTIES

- Solvent free
- Fast acting and drying
- Mild abrasive
- Removes ingrained dirt
- Clear and shiny finish
- Non-smearing
- Multi-purpose use
- Non-flammable

Product description	Colour	Packaging	Volume	Box	Pallet	Art. nr.
PVCu Cream Cleaner	White-beige	Bottle	1 l	12	480	113619



## 8. MAINTENANCE

### GLASS & MIRROR CLEANER

#### DESCRIPTION

Glass & Mirror Cleaner is a high performance, alcohol based cleaner specifically designed for removing most ingrained dirt, grease, finger marks, dust and other contaminants from glass, mirrors and glazed surfaces. Ready to use (no mixing required).

#### PROPERTIES

- Fast acting and drying
- Streak free
- Non-smearing
- Perfumed
- Multi-purpose use

Product description	Colour	Packaging	Volume	Box	Pallet	Art. nr.
Glass & Mirror Cleaner	Colourless	Bottle	1 l	12	480	113620
Glass & Mirror Foam Cleaner	Colourless	Aerosol	750 ml	12	672	156176

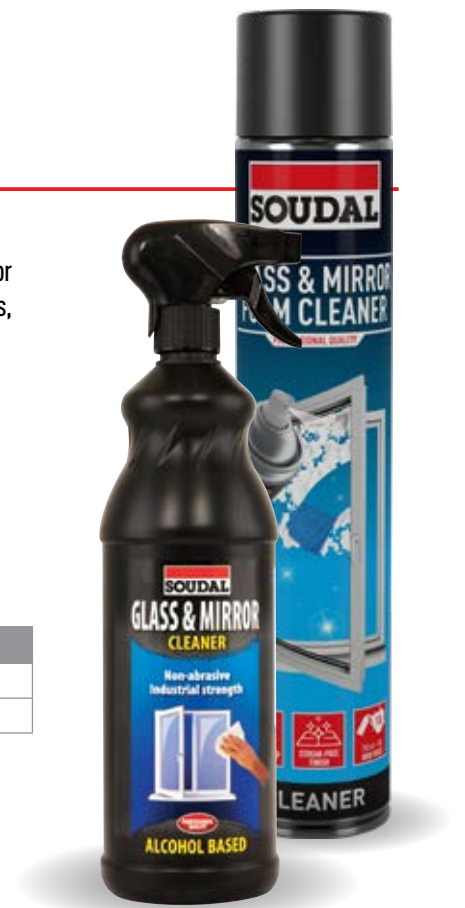

## 9. ACCESSORIES

### SILICONE SPRAY

#### DESCRIPTION

Transparent lubricating and anti-adhesive spray based on high performance silicone oils. Reduces friction and prevents wear and tear on moving plastic parts. Protects against dirt and grease. Suited for rubber and synthetic parts. Very high temperature resistance (up to 200°C).

#### PROPERTIES

- Silicone based
- Transparent
- Lubricates and protects
- Very high temperature resistance
- Aerosol can be used at any angle (360°)

Product description	Colour	Packaging	Volume	Box	Pallet	Art. nr.
Silicone Spray	Transparent	Aerosol	400 ml	6	1044	119704



### PTFE SPRAY



#### DESCRIPTION

High grade PTFE based lubricant. Repels water and dirt. Long life protection against friction and wear. Excellent mechanical and thermal stability. High penetration characteristics.

#### PROPERTIES

- PTFE based
- High pressure & temperature resistance
- Long life protection
- Lubricates and protects
- Aerosol can be used at any angle (360°)

Product description	Colour	Packaging	Volume	Box	Pallet	Art. nr.
PTFE Spray	White-yellow	Aerosol	400 ml	6	1044	119705



## 9. ACCESSORIES

### MULTI SPRAY



#### DESCRIPTION

High grade universal spray with 8-fold action: dust remover, lubricant, cleaner, penetrating oil, anti-corrosive, damp repellent, shock and contact spray. It does not corrode plastics or metals and leaves a protective film on surfaces after use.

#### PROPERTIES

- Universal spray
- 8-fold action
- Can be used on metals, plastics and rubbers
- Aerosol can be used at any angle (360°)

Product description	Colour	Packaging	Volume	Box	Pallet	Art. nr.
Multi Spray	White	Aerosol	400 ml	6	1044	119707



### CLEANER & DEGREASER

#### DESCRIPTION

Powerful quick drying industrial cleaner and degreaser for various maintenance and assembly applications. Can be used on most surfaces (metals, plastics, PVC, etc.) and leaves no residue.

#### PROPERTIES

- Cleans and degreases
- Quick-drying
- Aerosol can be used at any angle (360°)

Product description	Colour	Packaging	Volume	Box	Pallet	Art. nr.
Cleaner & Degreaser	Transparent	Aerosol	400 ml	6	1044	119708



## 9. ACCESSORIES

### DEGRIP ALL

#### DESCRIPTION

Degrip All is a high quality penetrating oil which dissolves rust and corrosion. Due to its low surface tension the product penetrates into very small cavities to release metal parts such as nuts, bolts, machine parts.

#### PROPERTIES

- High penetrating power
- Dissolves and protects against rust
- For interior and exterior applications
- Aerosol can be used at any angle (360°)

Product description	Colour	Packaging	Volume	Box	Pallet	Art. nr.
Degrip All	Transparent	Aerosol	400 ml	6	1044	119716



### MULTI CLEANER FOAM



#### DESCRIPTION

A universal cleaning foam spray. Foam action helps to break down dirt and contaminants. Does not drip.

#### PROPERTIES

- Cleans and degreases
- Highly soluble
- Does not drip
- Does not leave any residues
- Foam action

Product description	Colour	Packaging	Volume	Box	Pallet	Art. nr.
Multi Cleaner Foam	White	Aerosol	400 ml	6	1044	119711



## 9. ACCESSORIES

### PE GLAZING TAPE



#### DESCRIPTION

PE Glazing Tape is a flat, PE foam glazing tape with a single sided self-adhesive strip and a protective liner designed for window and door glazing applications. The black version is without a protective liner.

#### PROPERTIES

- Very smooth foam tape
- With protective liner
- High tack adhesive
- Available in various thicknesses

Product description	Colour	Packaging	Volume	Box	Pallet	Art. nr.
PE glazing tape	White	Tape	2x9 mm   20 m	-	-	110303
PE glazing tape	White	Tape	3x9 mm   20 m	-	-	110304
PE glazing tape without liner	Black	Tape	2x9 mm   25 m	-	-	106517
PE glazing tape without liner	Black	Tape	3x9 mm   25 m	-	-	106518
PE glazing tape without liner	Black	Tape	4x9 mm   25 m	-	-	106519
PE glazing tape without liner	Black	Tape	5x9 mm   10 m	-	-	106520



### DOUBLE-SIDED TRANSPARENT TAPE

#### DESCRIPTION

High performance transparent bonding tape with double sided adhesion for the initial fixing of mirrors and glass while the adhesive is curing.

#### PROPERTIES

- High adhesive strength
- With protective foil
- Easy to apply
- Excellent adhesion to many porous and smooth surfaces
- For in- and outside use
- UV-resistant
- Good resistancy to solvents

Product description	Colour	Packaging	Volume	Box	Pallet	Art. nr.
Double-sided transparent tape	Transparent	Tape	1x19 mm   33 m	-	-	123837
Double-sided transparent tape	Transparent	Tape	1x25 mm   33 m	-	-	123838



# EVERYTHING FOR THE WINDOW PROFESSIONAL



## PU-FOAM

FLEXIFOAM

## LIQUID MEMBRANES

SOUDATIGHT LQ

SOUDATIGHT SP

SOUDATIGHT HYBRID

SOUDATEXILE

## WINDOW TAPES

SWS VARIO EXTRA

SWS INSIDE EXTRA

SWS OUTSIDE EXTRA

SWS FLEXI TAPE INSIDE

SWS FLEXI TAPE OUTSIDE

SWS INSIDE STANDARD

SWS OUTSIDE STANDARD

EPDM MEMBRANE

## PRE-COMPRESSED JOINT SEALING TAPES

SOUDABAND PRO BG1

SOUDABAND PRO MF1

SOUDABAND AKTIV PLUS (PA)

SOUDABAND ACRYL 300

## SEALANTS

SOUDASEAL 215LM

SOUDASEAL 225



ACRYRUB SWS

SILIRUB PRO N

SILIRUB 2

SILIRUB COLOR

**WINDOW TAPES ADHESIVE**

SOUDAFOIL 330D

SOUDAFOIL 360H

**VAPOUR BARRIERS**

VAPOURSEAL

SOUDATAPE FACADE

SOUDATAPE CONNECT

SOUDATAPE FLEX

**PRIMER & CLEANERS**

PRIMER 150

SWIPEX

GUN & FOAM CLEANER

PU-REMOVER

**PRE-FRAME SYSTEM**

SOUDAFRAME SWI PROFILE

SOUDAFRAME SWI CLIP 20

SOUDAFRAME SWI CORNER

SOUDAFRAME SWI LINK

SOUDASEAL SWI



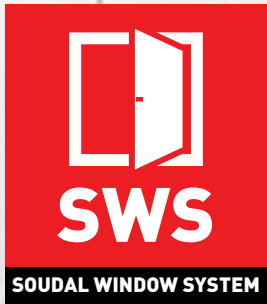

# THINK ABOUT YOUR AIRTIGHTNESS.



## **AIRTIGHTNESS:** **A SMALL INVESTMENT WITH A BIG IMPACT**

In order to meet the increasingly stringent EPB and NZEB requirements it's necessary to build airtight. An airtight building envelope minimises heat and energy losses and increases the energy efficiency of a building. Window connections play a crucial role in the building envelope.

Soudal Window System (SWS) is a professional window joint sealing system that offers a total solution for the airtight sealing between joinery and masonry. The SWS product range consists of a variety of products (sealants, PU foams, pre-compressed joint sealing tapes, self-adhesive tapes, membranes and liquid membranes), all of which can be perfectly combined. Soudal Window System always offers the best fitting solution regardless of the construction or installation method, both for new buildings and renovations and even when "passive" is the standard.

**SODAL NV**  
**EVERDONGENLAAN 18-20**  
**B-2300 TURNHOUT**  
**TEL.: +32 (0)14 42 42 31**  
**FAX: +32 (0)14 42 65 14**  
**EMAIL: SALES@SODAL.COM**  
**WWW.SODAL.COM**