



SOUDAL WINDOW SYSTEM

THE PROFESSIONAL
WINDOW JOINT SEALING SYSTEM

SOUDAL

SOUDAL

SOUDAL BUILD THE FUTURE

SOUDAL is Europe's leading independent manufacturer of adhesives, sealants and PU foams. This family-owned business with its headquarters in Turnhout, Belgium, was founded by Vic Swerts, in 1966. Nowadays, Soudal has become an international player and expert in chemical construction specialties. With more than 3800 employees worldwide and due to its continuous growth, improvements and innovations Soudal achieved a turnover of €1,1 billion, in 2021.

Soudal has a long-term vision on innovation and wants to achieve this by focusing on R&D for the development of new and innovative solutions, and by continuously improving and optimizing existing products. The aim of Soudal is to supply innovative and high-quality products that meet the high demands and needs of end-users and the market.



Experts in bonding & sealing
#madewithsoudal

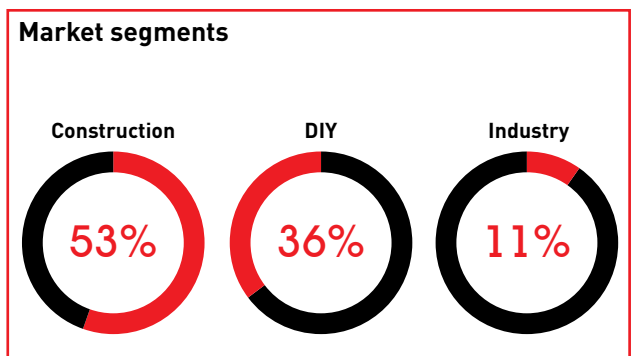

SOUDAL

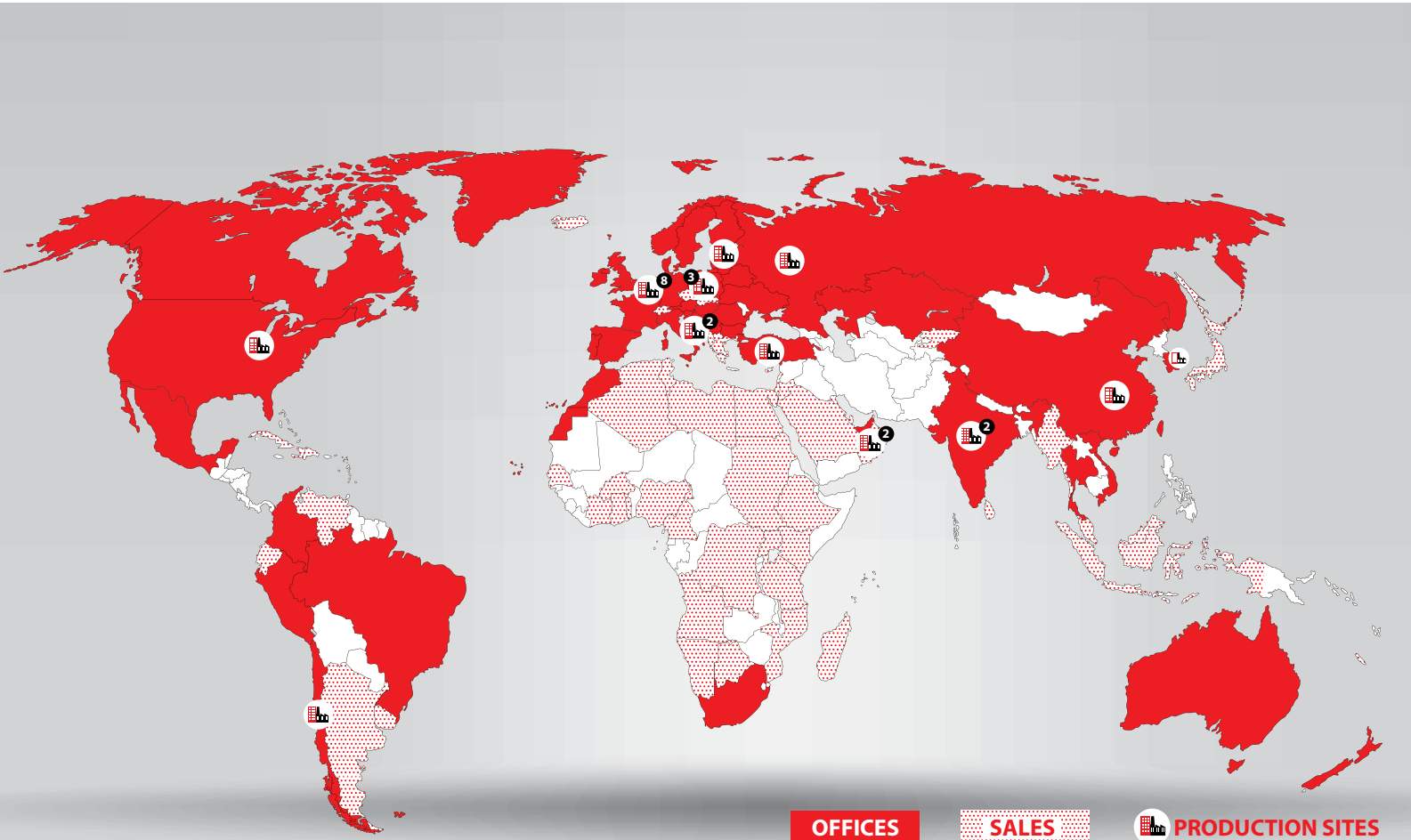

OFFICES

SALES

PRODUCTION SITES

SOUDAL

RELIABLE PARTNER

FROM GLASS TO WALL

INSULATION OF
WINDOW FRAMES

Sapac



PRODUCTION OF
IGU SEALANTS

TenaChem



WINDOW
FABRICATION

Soudal Window
Manufacturing



ONE-STOP
SUPPLIER

#MADEWITHSOUDAL

WINDOW INSTALLATION

Soudal Window
Installation



WINDOW SEALING

Soudal Window
System



SOUDAL

BUILD THE FUTURE

RELIABLE PARTNER

Soudal has been a reliable partner for decades supplying the construction world and industry with reliable, innovative and up-to-date quality products that boast user-friendliness. Thanks to an international sales structure and an excellent market penetration, Soudal is able to supply these products swiftly to customers worldwide. Windows & Doors (Fenestration) have been a major focus of Soudal's dedicated marketing and sales team; manufacturers and installers alike are familiar with the Soudal brand and stick with it for window fabrication, installation and sealing. Soudal bundled all of its experience and knowledge together in 3 different window system solutions. These systems offer a complete range of products and solutions that match the industry's needs perfectly.



Soudal Window Manufacturing (SWM)

Soudal Window Manufacturing is a system solution for window & door fabricators. With SWM, Soudal offers a wide and complete range of products for the window and door industry. The range includes products for the production of double glass, the fabrication of windows and doors, to the installation and durable airtight finishing in the construction site.



Soudal Window Installation (SWI)

SoudaFrame SWI is an intelligent modular pre-frame system for the installation of exterior joinery, made from glass fibre reinforced plastic (GFRP). This Passive House certified system ensures a thermally optimal window installation, without thermal bridges. The system can be used universally for new builds and renovations and is available in various sizes.



Soudal Window System (SWS)

Soudal Window System offers a solution for the increasingly stringent expectations and requirements regarding the energy performance of buildings, by combining (certified) high-quality products for a long-lasting, well insulated, airtight and weatherproof seal around window & door connections. Through its diversity in products (sealants, PU-foams, pre-compressed tapes, (liquid) membranes and self-adhesive tapes) SWS can always offer the right combination and solution regardless of the building or installation method!



LEGISLATION



The energy performance of buildings is based on European legislation, in particular the original directive 2002/91/EC, also called the EPBD. This directive was in line with the “20-20-20 targets” of the European Union: to reduce CO₂ gas emissions by 20%, to reduce energy consumption by 20% and to increase the share of renewable energy to 20% (reference year: 1990). Other considerations played a role as well, such as a reduced dependency on non-European energy sources. The subject of renewable energy is further detailed in European Directive 2009/28/EC; a minimum renewable energy share will also be slowly introduced into the energy performance requirements for new buildings.

Because the current path could not ensure a 20% reduction in energy consumption by 2020, Europe created the 2012/27/EC Directive. This directive covers the general subject “energy efficiency” and came into effect in December 2012. It mainly affects existing houses and buildings. Belgium, for example, has set targets for each of its 3 regions, which should result in an annual energy saving of 1,5% for the period 2014-2020. Energy policy agreements for companies are an example of this, just like the better known premium systems through distribution network operators, mostly effecting the existing building stock.

NZEB

The recast of the energy performance directive (2010/31/EC) included not only stricter requirements for new buildings and renovations, and a stronger role for the energy performance certificate, but also the introduction of the term NZEB (Nearly Zero Energy Building). The description in the recast was:

“A building with a very high energy performance, as set out in Appendix I. The nearly zero or very low amount of energy required should be covered to a very significant extent by energy from renewable sources, including energy from renewable sources produced on-site or nearby.”

As of 2021, all newly built houses in Europe have to be NZEB!

In the run-up to 2021, the energy performance requirement for new buildings have become more strict. Simultaneously, an increasingly large mandatory share of renewable energy will have to be realised. As this European legislation has been set out in a Directive, all member states had to convert this European policy into national legislation and integrate it into local energy policies. Since 2021, NZEB buildings are the standard for all new homes across the whole of Europe!

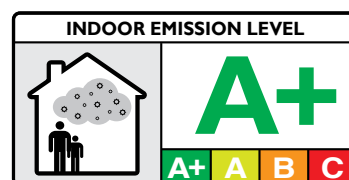

PASSIVE HOUSE

The passive house concept is based on the ideas developed by Dr. Feist at the University of Darmstadt (Germany) in the 1990s.

It was founded on the Trias Energetica:

- Prevention: limit energy consumption by avoiding waste
- Use sustainable sources of energy as much as possible
- Use fossil fuels as efficiently as possible to meet the remaining energy needs

For translating this principle into building practice, it is of prime importance to take great care ensuring the building envelope is very well insulated and airtight. Attention should also be paid to compactness, good orientation and, of course, controlled ventilation. In the original concept the ventilation ducts were also used for heating purposes; due to the absence of a classic 'active' heating system this type of house was called a passive house.

Meanwhile other "heating aids" are being used but the basic criteria for a passive house have remained the same:

- Net energy need for heating $\leq 15 \text{ kWh/m}^2$ per year
- Airtightness n50-value $\leq 0,6 \text{ vol/h}$
- Temperature exceedance factor above $25^\circ\text{C} \leq 5\%$

This translates into a building which has, in winter as well as summer, a very comfortable interior climate and requires only a minimum amount of heating. It is obvious that a passive house is the ideal way to achieve an NZEB as the limited energy needed can easily be met by renewable energy. Meaning: Zero Energy Ready! For this reason, in 2015, the Brussels District (Belgium) opted for the passive house standard for all newly built houses in the run-up to 2021. Brussels obviously wants to play a pioneering role as the European capital!

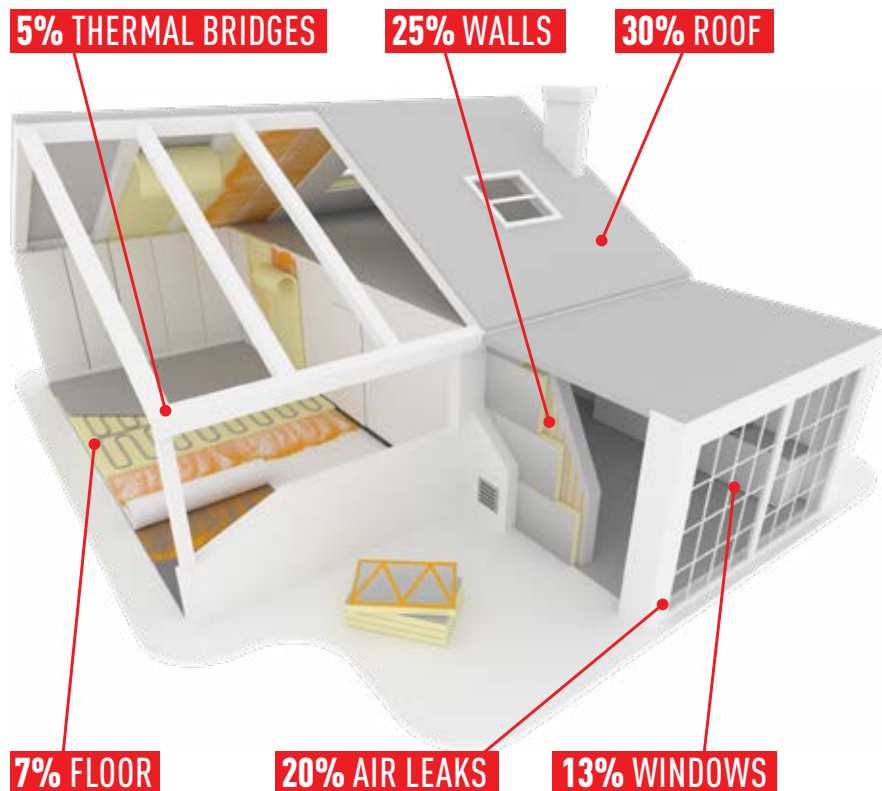

AIRTIGHTNESS

It has become very difficult to achieve the increasingly stringent energy requirements without paying attention to airtightness. Air leaks (uncontrolled ventilation) cause heat and energy losses, draft, poor acoustics and moisture problems. Good airtightness goes hand in hand with a high quality building envelope and is one of the most economical ways to improve the energy performance of a building.

“A small investment with a big impact on the energy efficiency: paying attention to airtightness when building a house (e.g. a leak flow of 2 to 3 m³ per hour per m²) may result in a reduction of the E-value by 5 to 15 E-value points. This is measured by a pressurisation test (BlowerDoor). If a house is not tested, it is assumed that it has a lesser airtightness of 12 m³ per hour per m². The net energy requirement will also substantially decrease.”

The airtightness or blower door test is regulated according to the European standard EN13829 (method A or B). During an airtightness test the air leakage is measured at an under- and overpressure, each time with a pressure difference of 50 Pa. The measured result is the air leak rate of the building, expressed in air changes per hour (ACH or n50) or air permeability. In some countries the value for the report is recalculated at 4 Pa (France) or 10 Pa (the Netherlands). In order to achieve accurate measurements, many countries have implemented a quality framework for testers.

Window-to-wall joints are of crucial importance; poor execution accounts for an estimated 15% of the total air loss in an average detached house. The Soudal Window System (SWS) is therefore an important contribution to good airtightness.





BlowerDoor GmbH
MessSysteme für Luftdichtheit

www.blowerdoor.de

SUDAL WINDOW SYSTEM

**A PROFESSIONAL JOINT SEALING
SYSTEM FOR EXTERIOR JOINERY**

SOUDAL WINDOW SYSTEM (SWS)

For many years Soudal has been offering a comprehensive range of high quality products for sealing and insulation that can be used for the installation of windows and doors. Together with installers, building promoters and architects, Soudal has combined all its know-how related to window joints in the Soudal Window System (SWS). SWS is a professional window joint sealing system, that focuses on the sealing between joinery and masonry. Because exterior joinery and connections play a crucial role in the energy performance of a building, SWS offers a great solution for the increasingly stringent EPB-requirements by combining high-quality products for a long-lasting airtight, well-insulated and weatherproof sealing around windows and doors.

A 3-level sealing solution

The optimal sealing of window joints is done at 3 levels: airtightness on the inside, thermal and acoustic insulation in the middle, and excellent protection against all sorts of weather influences (wind, UV and driving rain) on the outside. This is done in accordance with EnEV, DIN 4108-7 and the directives for a RAL installation.



「A GOOD WINDOW BADLY INSTALLED IS A BAD WINDOW!」

All building details are important under the EPB directive, so window joints too. What use are ultra-insulating walls, window frames and glazing in a building if thermal bridges or air leaks between them mean heat and energy are lost?

3 LEVEL WINDOW JOINT SEALING

OUT

OUTSIDE

MID

MIDDLE

IN

INSIDE

WEATHER RESISTANCE:

- **Driving rain tight:** keeps water from outside penetrating the building envelope
- **Vapour permeable:** promotes water vapour to evacuate to the outside
- **Air- and wind tight:** prevents the movement of air due to atmospheric pressure from outside (wind)

INSULATION:

- **Acoustic:** avoids noise, vibrations of building elements from traveling through the building envelope
- **Thermal:** limits thermal exchange between the outside and the inside and minimizes the energy consumption needed to maintain the required temperature

AIRTIGHTNESS:

- **Airtight:** prevents the movement of air due to atmospheric pressure from inside
- **Vapour retardant:** regulates the infiltration of internal moisture into the connection joint

THE SWS MODEL

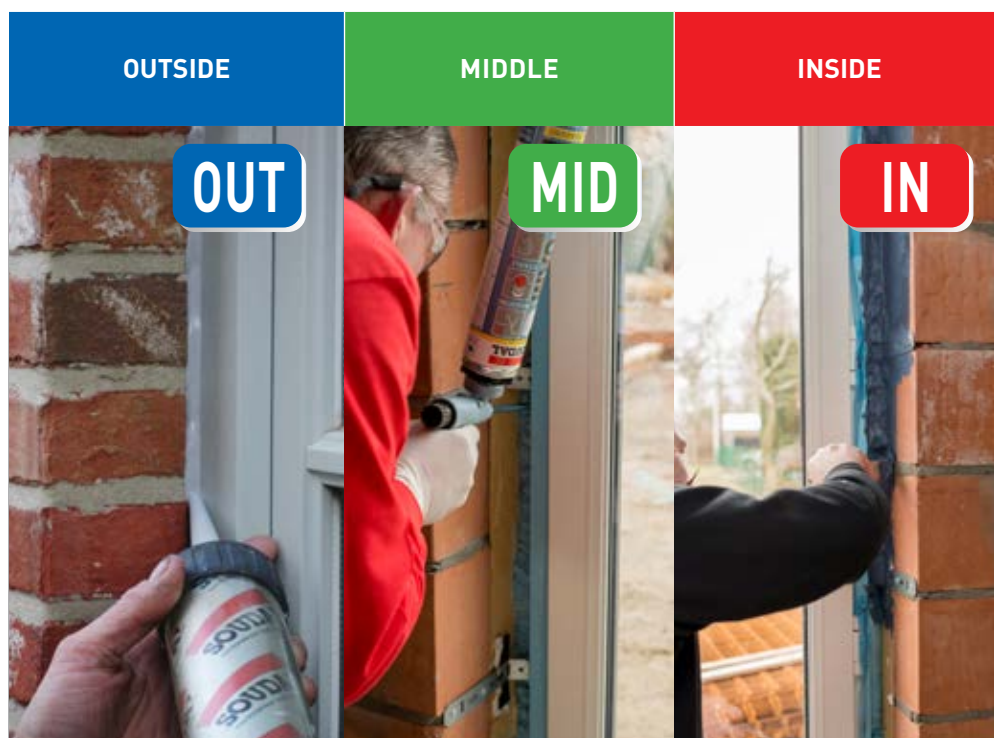

		OUTSIDE	MIDDLE	INSIDE
		OUT	MID	IN
Choose your preferred product for each level:		Function : <ul style="list-style-type: none"> • Driving rain tight • Air- and wind tight • Vapour permeable 	Function : <ul style="list-style-type: none"> • Acoustic insulation • Thermal insulation 	Function : <ul style="list-style-type: none"> • Airtightness • Vapour retardant
PU foam			Flexifoam Flexifoam X-tra	
Liquid membranes		Soudatight Hybrid Soudatight WP		Soudatight LQ Soudatight SP
Membranes		SWS Outside Standard SWS Outside Extra SWS Vario Extra		SWS Inside Standard SWS Inside Extra SWS Vario Extra
Pre-compressed tapes		Soudaband PRO BG-1 Soudaband PRO MF1 Soudaband PRO SFD	Soudaband Acryl 300 Soudaband PRO MF1 Soudaband PRO SFD	Soudaband PRO MF1
Sealants	Hybrid	Soudaseal 215 LM		Soudaseal 215 LM
	Acrylic			Acryrub SWS
	Silicone	Silirub PRO N Silirub WS Silirub MA Silirub 2 Silirub Color		Silirub PRO N Silirub WS Silirub MA Silirub 2 Silirub Color

CLICK & FIX

FLEXI FOAM X-TRA

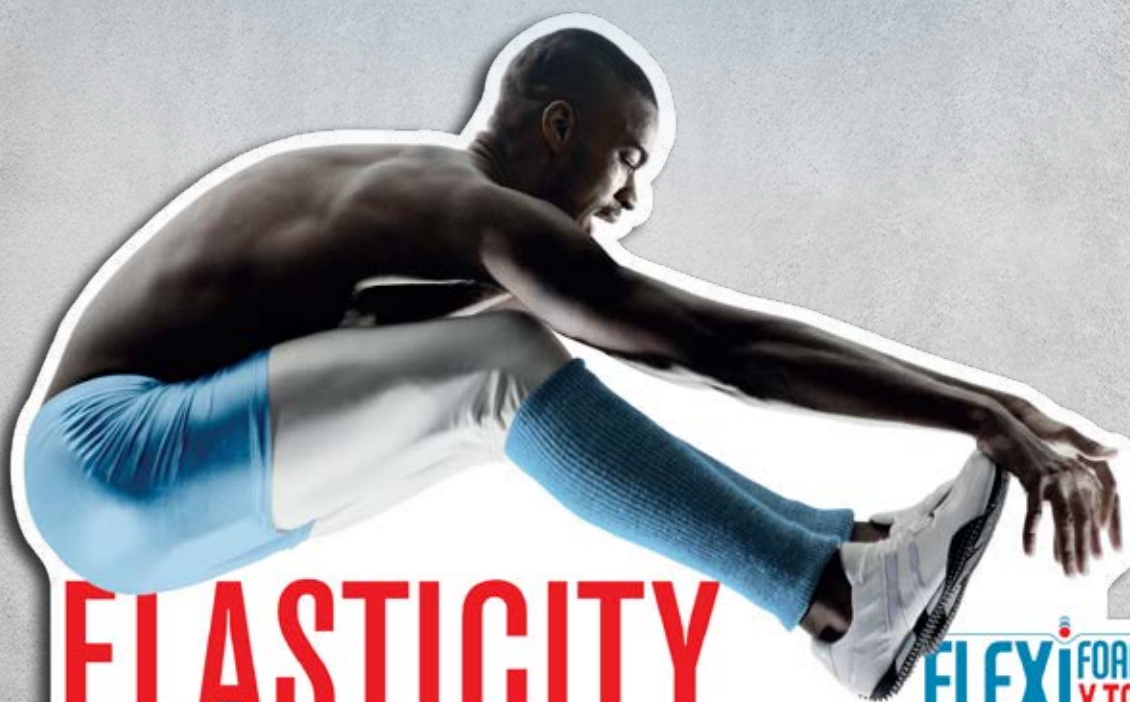

ELASTICITY AND BEYOND

FLEXI FOAM
X-TRA

+30%

HIGHER
YIELD

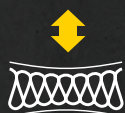

X-TRA
ELASTICITY

A+

LOW ENERGY



AIRTIGHT



THERMAL
INSULATION



ACOUSTIC
INSULATION

B1

LOW
FLAMMABILITY



ALL
SEASONS



FLEXIBLE PU-FOAM

MID

NEW



VERY LOW EMISSION EC1+
For a healthy living environment

INNOVATIVE DURAVALVE®

- Multi position storage (vertical / horizontal)
- Perfectly reusable, optimal yield without residual quantities
- Shelf life extended to 24 months

FLEXIFOAM X-TRA

Flexifoam X-tra Click & Fix is a NEW generation premium foam, equipped with the patented Click & Fix® system that ensures extra user-friendliness and an optimal and fast application.

Flexifoam X-tra is an X-tra flexible PU-foam, that is even better in following joint movements, both when compressed and elongated. Because of the X-tra flexibility the product maintains its insulating properties for many years, therefore contributing to the long-term airtightness and energy efficiency of the building. As an additional benefit Flexifoam X-tra has an X-tra joint yield of up to +30% in comparison with standard flexible foams. Flexifoam X-tra is especially developed for window applications. It can absorb joint movements in two directions (compressed and elongated), which ensures a high-quality thermal and acoustical insulation and a long-lasting seal, without thermal bridges.

PROPERTIES:

- X-tra Flexible
- 50% movement capabilities (elongation & compression)
- Long lasting elasticity
- Higher yield (+30%)
- More durable performance
- Long lasting airtightness (before and after ageing)
- Low expansion
- Fast curing
- All seasons -5°C - +35°C
- Fire class B1 (DIN4102-B1)
- Low emission: EC1+
- Ift certified



COMBIBOX

10X FLEXIFOAM X-TRA CLICK & FIX
1X CLICK & CLEAN
1X CLICK & FIX PROFI GUN

Technical specifications

Thermal insulation (EN 12667) $\lambda = 0,0336 \text{ W/m.K}$	MFPA Leipzig
Acoustic insulation (EN ISO 717-1) 62dB	ift-Rosenheim
Water vapour permeable (EN ISO 12572) $\mu = 13$	ift-Rosenheim
Airtightness (DIN 18542) Tested before and after ageing $a < 0,1 \text{ m}^3 / (\text{h.m (daPa)}^2/3)$	ift-Rosenheim
Elasticity 3x3000 cycles	ift-Rosenheim
Fire Class (DIN 4102-1) B1	MFPA Leipzig

FLEXIBLE PU-FOAM

MID

FLEXIFOAM

Top-grade gun applied elastic PU foam with outstanding insulation characteristics combined with ease of use. Absorbs joint movements and guarantees a durable thermal and acoustic insulation.

Specially developed for window installation in accordance with the EPB rules by avoiding thermal bridges. Very precise application, low post expansion, very economic in use. Fast skin formation and curing, which results in shorter waiting times. Can also be used in winter at below 0°C temperatures. Recognisable blue colour. Available in screw thread and Click&Fix®. Very low VOC emissions (EC1 Plus).

PROPERTIES:

- Flexible
- Good acoustic insulation
- Excellent thermal insulation
- Airtightness: $a < 0,1 \text{ m}^3 / (\text{h.m (daPa)}^{2/3})$
- Water vapour permeable
- Excellent stability (no shrinkage or post expansion)
- Innovative Duravalve for optimum yield

VERY LOW EMISSION EC1+

For a healthy living environment

INNOVATIVE DURAVALVE®

- Multi position storage (vertical / horizontal)
- Perfectly reusable, optimal yield without residual quantities
- Shelf life extended to 24 months



ACOUSTIC INSULATION IN DB

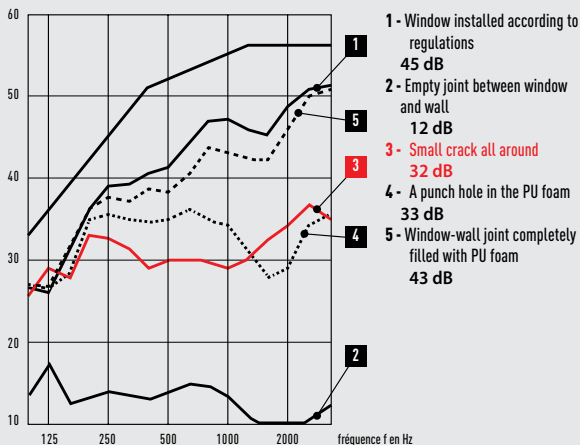

Source: Installation guide, RAL-Gütegemeinschaft Fenster und Haustüren, Ffm.

Technical specifications

Thermal insulation (DIN 52612-1)

$\lambda = 0,0345 \text{ W/(m.K)}$

MPA Hannover

Acoustic insulation (EN ISO 717-1)

RST,w = 63 dB (-1;-5) (joint 10mm)

RST,w = 62 dB (-1;-4) (joint 20mm)

ift-Rosenheim

Water vapour permeable (EN ISO 12572)

$\mu = 20$

ift-Rosenheim

Airtightness (DIN 18542, Part 7.2)

$a < 0,1 \text{ m}^3 / (\text{h.m (daPa)}^{2/3})$

ift-Rosenheim

Elasticity (FEICA TM 1013)

9000 cycles ift-Rosenheim

1 x 1000 cycles





LIQUID MEMBRANES

No more fuss with window anchors and carefully folding window tapes. The Soudatight liquid membranes form a completely jointless and elastic membrane that perfectly follows the shape of the surface and guarantee an excellent airtightness. For both internal and external use.



SOUDATIGHT LQ

Brushable fibre-reinforced air- and vapour retardant liquid membrane

IN

DESCRIPTION:

Soudatight LQ is a high quality, fibre-reinforced polymer that forms a seamless air- and vapour retardant elastic membrane after drying. Use Soudatight LQ for the airtight and vapour retardant finishing of penetrations and window, floor-wall, wall-ceiling and roof joints. The product can be very simply applied with a flat brush.

PROPERTIES:

- Airtight
- Vapour retardant
- Seamless, flexible coating
- Glass fibre-reinforced (crack bridging up to 5 mm)
- Stays elastic after curing
- Can be painted, plastered or taped after drying
- For inside use only
- Available in blue (turns black after curing) and white



SOUDATIGHT SP

Professional sprayable air- and vapour retardant liquid membrane

IN

DESCRIPTION:

Soudatight SP - the sprayable version - forms a seamless air- and vapour retardant elastic membrane on larger surfaces and in floor-wall, wall-ceiling, ... joints. Soudatight SP is applied using professional airless spraying tools or with the Jetflow 3 Foil Bag spray gun.

PROPERTIES:

- Airtight
- Vapour retardant
- Seamless, highly flexible coating
- Fast and easy application
- Stays elastic after curing
- Can be painted, plastered or taped after drying
- For inside use only
- Available in blue (turns black after curing) and white



LIQUID MEMBRANES



SOUDATIGHT HYBRID

Brushable and sprayable air- and driving rain tight liquid membrane

IN OUT

DESCRIPTION:

Soudatight Hybrid - the hybrid version - is designed for both internal and external use. This product allows the very simple and quick application of a seamless vapour permeable, air- and driving rain tight elastic membrane on penetrations, joints and surfaces (no roof applications). Soudatight Hybrid can be applied in beads or as a coating with the Jetflow 3 Foil Bag spray gun.

PROPERTIES:

- Airtight
- Driving rain tight
- Seamless, highly flexible coating
- Vapour permeable
- Stays elastic after curing
- Can be painted, plastered or taped after drying
- For outdoor use (indoor use also possible)



LIQUID MEMBRANES

OUT

SOUDATIGHT WP

Brushable airtight and waterproof liquid membrane

NEW



DESCRIPTION:

Soudatight WP is a high-quality one component hybrid based liquid membrane, designed for waterproofing window-to-floor connections (terraces and balconies). After curing, the product forms a seamless, waterproof elastic membrane that can be painted or plastered over. Soudatight WP should be applied in two-layers, and reinforced with Soudatextile in between layers.

PROPERTIES:

- 1-component ready-to-use system
- Watertight
- Airtight
- Vapour permeable
- Stays elastic
- For outdoor use
- Water stagnation system test report (HFA)



LIQUID MEMBRANES ACCESSORIES



FLAT BEAD NOZZLE (S15)

Flat bead nozzle for foil pack dispensers.

DESCRIPTION:

Flat bead nozzle available in two widths: 20 mm and 30 mm. To be used in combination with Foil bag adapter (S15). Suitable for applications with a foil pack dispenser. Mainly suited for Soudatight LQ and Soudatight Hybrid foil pack applications, can also be used for Soudatight SP.

PROPERTIES:

- Flat bead nozzle 20 and 30 mm
- Precise and efficient application
- Suitable for foil pack dispensers
- To be used in combination with S15 foil bag adapter
- Easy layer thickness control 2 mm



FOIL BAG ADAPTER (S15)

Adapter for foil pack dispensers.

DESCRIPTION:

Standard (S15) adapter for flat nozzles. Compatible with 20 mm and 30 mm flat bead nozzle (S15). Mainly suited for Soudatight LQ foil pack applications with manual dispensers, can also be used for Soudatight SP and Hybrid.

PROPERTIES:

- Suitable for foil pack dispensers
- Compatible with flat bead nozzles 20 and 30 mm

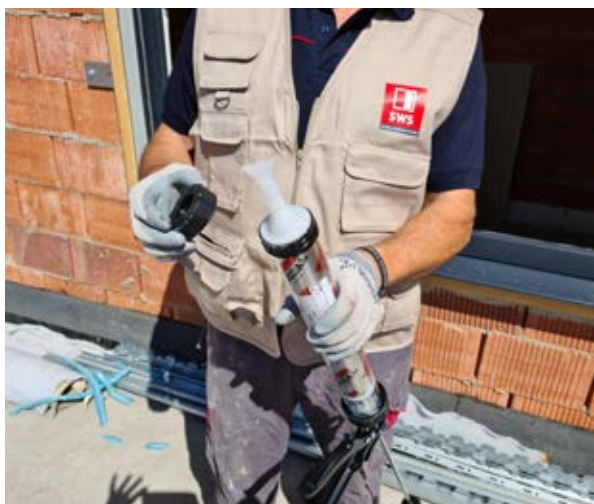

LIQUID MEMBRANES ACCESSORIES

IN OUT



SOUDATEXILE

Non-woven fleece for use in combination with Soudatight liquid membranes

DESCRIPTION:

Soudatextile is a non-woven fleece made from polypropylene, needle punched and heat-treated, produced without adhesive or chemical binder for use in combination with Soudatight liquid membranes for larger seam, gap and crack bridging applications. 150 mm x 20 m roll.

PROPERTIES:

- Easy to apply
- Density: 110 g/m²
- Thickness: 0,80 mm
- Flexible
- Up to 30 days weatherproof
- Reinforcement layer for Soudatight WP



COX JETFLOW 3 FOIL BAG

Pneumatic gun for Soudatight Hybrid and SP

DESCRIPTION:

Multifunctional pneumatic gun for spraying Soudatight Hybrid and Soudatight SP. Switch from a bead to spraying pattern by a simple twist.

ACCESSORIES :

131896: 10 sets of nozzles for Cox Jetflow 3 Foil Bag

PROPERTIES:

- Lightweight and ergonomically designed pneumatic gun
- Easy adjustment between bead and spray application with one twist
- Variable speed regulator for precise control and smooth material flow
- Special nozzle set included for a wide range of bead and spray patterns
- Built-in silencer



MULTIFUNCTIONAL JOINT SEALING TAPES

Multifunctional joint sealing tapes are expansion tapes that seal joints on multiple levels: airtight on the inside, insulating in the middle and weather resistant on the outside. In the Soudaband range, Soudal offers two multifunctional joint sealing tapes with varying dimensions and qualities. These tapes are an all-in-one solution, that sustain the energy performance of the window joint.

NEW



SODABAND PRO MF1

MF1 classified multifunctional joint sealing tape

IN **MID** **OUT**

DESCRIPTION:

Soudaband PRO MF1 is a multifunctional pre-compressed joint sealing tape, that meets the new DIN 18542:2020 MF1 requirements. This premium all-in-one joint sealing tape combines all 3 levels of the SWS professional joint sealing system in one single product: driving rain tightness up to 1050 Pa on the outside, thermal and acoustic insulation in the middle and airtightness on the inside of the joint.

PROPERTIES:

- MF1 classified according to DIN18542:2020
- All-in-one product: 3-level sealing
- Driving rain tight up to 1050 Pa
- UV-resistant and weatherproof
- Vapour permeable: high joint drying potential
- Air- and wind tight
- High performing thermal insulation
- Exceptionally good acoustic insulation properties (R S,W 64 dB)
- Joint sizes of up to 30 mm (width)



NEW



SODABAND PRO SFD

A dedicated range of BG1 classified pre-compressed joint sealing tape adapted to its specific application

MID **OUT**

DESCRIPTION:

Soudaband PRO SFD is a multifunctional pre-compressed joint sealing tape, that meets the DIN 18542:2020 class BG1 requirements. Soudaband PRO SFD is driving rain tight on the outside, thermally and acoustically insulating in the middle and windproof on the inside of the joint.

PROPERTIES:

- BG1 classified according to DIN18542:2020
- Two-in-one product: 2-level sealing
- Driving rain tight up to 750 Pa
- Vapour-permeable: high joint drying potential
- High performing thermal and acoustic insulation
- UV-resistant and weatherproof



MULTIFUNCTIONAL JOINT SEALING TAPES

Art. nr.	Description	Variant	Colour	Min. joint width	Max. joint width	Depth window profile	Meter/roll	Rolls/box	Meter/box
155888	Soudaband PRO MF1 53/4-10	53/4-10	Black	4	10	53	12	9	108
155889	Soudaband PRO MF1 53/6-15	53/6-15	Black	6	15	53	8	9	72
155890	Soudaband PRO MF1 53/10-20	53/10-20	Black	10	20	53	6	9	54
155891	Soudaband PRO MF1 53/15-30	53/15-30	Black	15	30	53	4	9	36
155892	Soudaband PRO MF1 63/4-10	63/4-10	Black	4	10	63	12	7	84
155893	Soudaband PRO MF1 63/6-15	63/6-15	Black	6	15	63	8	7	56
155894	Soudaband PRO MF1 63/10-20	63/10-20	Black	10	20	63	6	7	42
155905	Soudaband PRO MF1 63/15-30	63/15-30	Black	15	30	63	4	7	28
155906	Soudaband PRO MF1 73/4-10	73/4-10	Black	4	10	73	12	6	72
155907	Soudaband PRO MF1 73/6-15	73/6-15	Black	6	15	73	8	6	48
155908	Soudaband PRO MF1 73/10-20	73/10-20	Black	10	20	73	6	6	36
155909	Soudaband PRO MF1 73/15-30	73/15-30	Black	15	30	73	4	6	24
155910	Soudaband PRO MF1 83/4-10	83/4-10	Black	4	10	83	12	5	60
155887	Soudaband PRO MF1 83/6-15	83/6-15	Black	6	15	83	8	5	40
155911	Soudaband PRO MF1 83/10-20	83/10-20	Black	10	20	83	6	5	30
155942	Soudaband PRO MF1 83/15-30	83/15-30	Black	15	30	83	4	5	20

Art. nr.	Description	Variant	Colour	Min. joint width	Max. joint width	Depth window profile	Meter/roll	Rolls/box	Meter/box
157129	Soudaband PRO SFD 30/4-10	30/4-10	Black	4	10	30	12	16	192
157128	Soudaband PRO SFD 30/6-15	30/6-15	Black	6	15	30	8	16	128
157127	Soudaband PRO SFD 30/10-20	30/10-20	Black	10	20	30	6	16	96
157126	Soudaband PRO SFD 35/4-10	35/4-10	Black	4	10	35	12	14	168
157125	Soudaband PRO SFD 35/6-15	35/6-15	Black	6	15	35	8	14	112
157124	Soudaband PRO SFD 35/10-20	35/10-20	Black	10	20	35	6	14	84
157123	Soudaband PRO SFD 40/4-10	40/4-10	Black	4	10	40	12	12	144
157122	Soudaband PRO SFD 40/6-15	40/6-15	Black	6	15	40	8	12	96
157120	Soudaband PRO SFD 40/10-20	40/10-20	Black	10	20	40	6	12	72

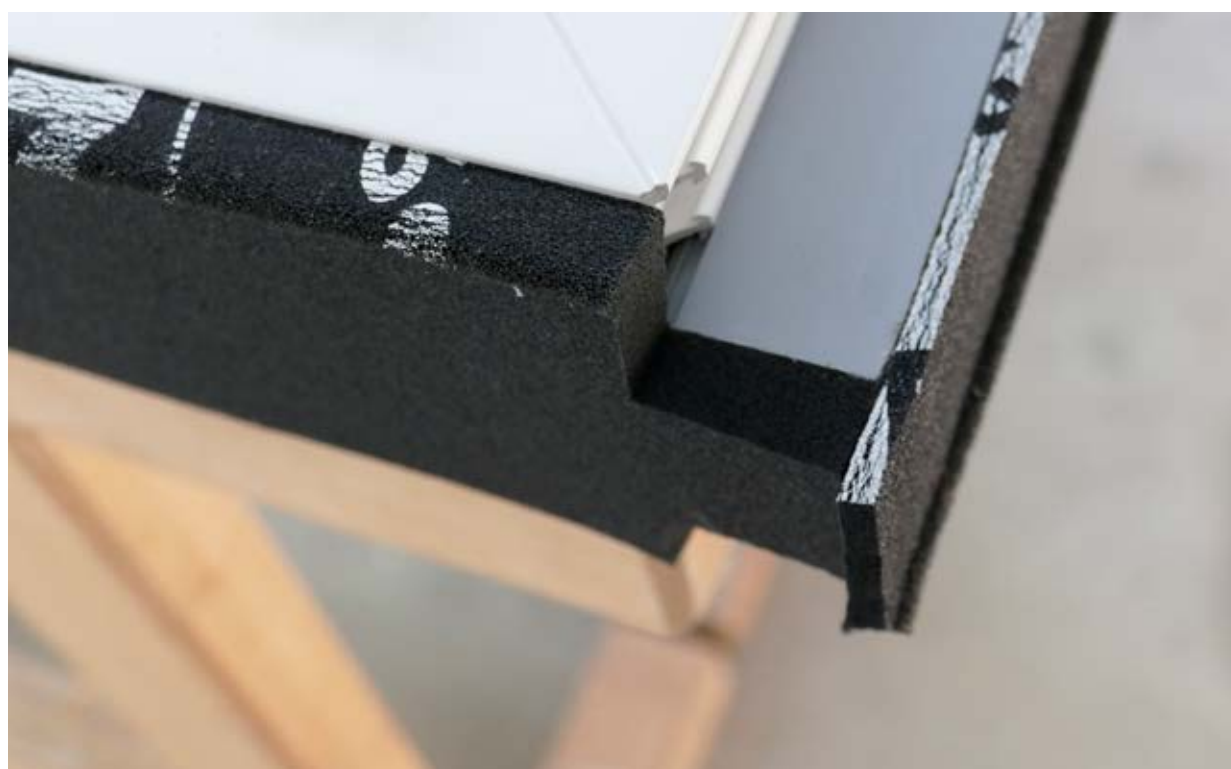

PRE-COMPRESSED JOINT SEALING TAPES

Thanks to their versatility expansion tapes have already been widespread in the construction sector for years. From window joints to dilation joints in concrete façade elements. Soudal offers a complete range of joint sealing tapes with different dimensions and qualities, both standardised and non-standardised.



SOUDABAND PRO BG-1

OUT

BG1 classified pre-compressed joint sealing tape for high-rise buildings

DESCRIPTION:

Standardised, pre-compressed joint sealing tape for sealing façade joints. Meets the strict requirements of DIN 18542:2020 BG1. Resistant against driving rain up to at least 750 Pa and suitable for uncovered joints (UV resistant). Ideal for sealing connections in high- and low-rise buildings.

PROPERTIES:

- Driving rain tight up to 750 Pa
- Windtight
- Vapour permeable
- UV resistant and weatherproof
- Adapts to fill unevenness and joint movements
- Also available in grey



SOUDABAND ACRYL 300

MID

Pre-compressed joint sealing tape

DESCRIPTION:

Soudaband Acryl 300 is a non-standardised impregnated, pre-compressed joint sealing tape for sealing joints and connections on the inside or as a backfilling for exterior use. Ideal for fitting external joinery behind cladding if further sealed with e.g. Soudaseal 215 LM.

PROPERTIES:

- Acoustic and thermally insulating
- Dustproof
- Windproof
- Vapour permeable
- Stays elastic
- Compatible with all sealants

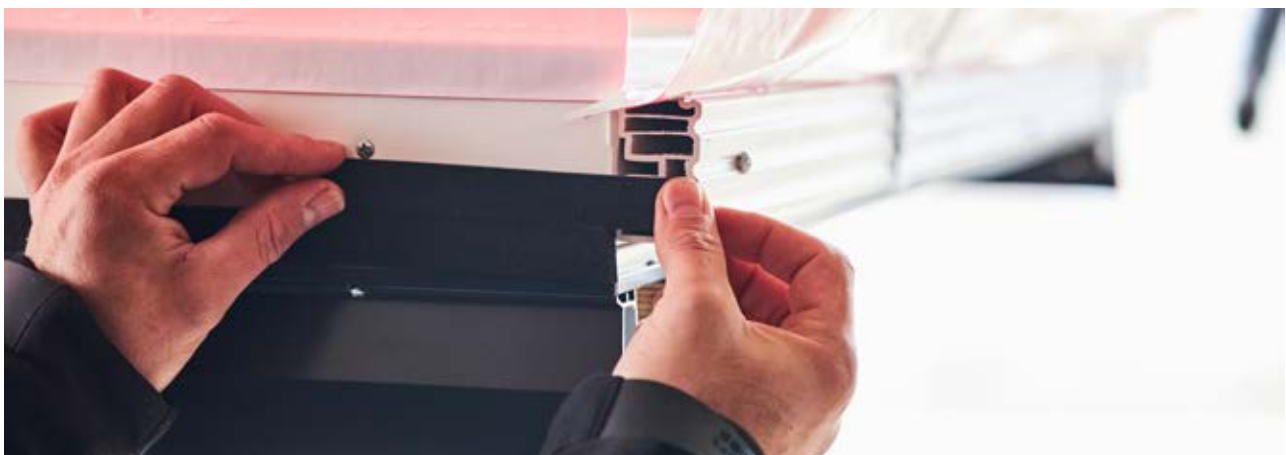

PRE-COMPRESSED JOINT SEALING TAPES

Art. nr.	Description	Colour	Min. joint width	Max. joint width	Tape width = min. joint depth	Meter/roll	Rolls/box	Meter/box
157806	Soudaband PRO BG-1 10/1-2	Black	1	2	10/1-2	20	32	640
157845	Soudaband PRO BG-1 15/1-2	Black	1	2	15/1-2	20	21	420
157844	Soudaband PRO BG-1 10/1-4	Black	1	4	10/1-4	15	32	480
157843	Soudaband PRO BG-1 15/1-4	Black	1	4	15/1-4	15	21	315
157842	Soudaband PRO BG-1 20/1-4	Black	1	4	20/1-4	15	16	240
157841	Soudaband PRO BG-1 30/1-4	Black	1	4	30/1-4	15	10	150
157840	Soudaband PRO BG-1 10/2-6	Black	2	6	10/2-6	12	32	384
157839	Soudaband PRO BG-1 15/2-6	Black	2	6	15/2-6	12	21	252
157838	Soudaband PRO BG-1 20/2-6	Black	2	6	20/2-6	12	16	192
157837	Soudaband PRO BG-1 30/2-6	Black	2	6	30/2-6	12	10	120
157836	Soudaband PRO BG-1 15/4-9	Black	4	9	15/4-9	10	21	210
157835	Soudaband PRO BG-1 20/4-9	Black	4	9	20/4-9	10	16	160
157834	Soudaband PRO BG-1 30/4-9	Black	4	9	30/4-9	10	10	100
157833	Soudaband PRO BG-1 15/5-12	Black	5	12	15/5-12	8	21	168
157832	Soudaband PRO BG-1 20/5-12	Black	5	12	20/5-12	8	16	128
157831	Soudaband PRO BG-1 15/8-15	Black	8	15	15/8-15	5	21	105
157830	Soudaband PRO BG-1 20/8-15	Black	8	15	20/8-15	5	16	80
157829	Soudaband PRO BG-1 20/10-20	Black	10	20	20/10-20	4	16	64
157828	Soudaband PRO BG-1 25/10-20	Black	10	20	25/10-20	4	12	48
157827	Soudaband PRO BG-1 25/13-24	Black	13	24	25/13-24	3	12	36

Also available in grey

Art. nr.	Description	Colour	Min. joint width	Max. joint width INSULATION	Max. joint width BACKFILLING	Tape width = min. joint depth	Meter/roll	Rolls/box	Meter/box
126612	Soudaband ACRYL 300 10/2	Anthracite	2 mm	3 mm	8 mm	10 mm	12,5	30	375
126614	Soudaband ACRYL 300 15/2	Anthracite	2 mm	3 mm	8 mm	15 mm	12,5	20	250
126711	Soudaband ACRYL 300 20/2	Anthracite	2 mm	3 mm	8 mm	20 mm	12,5	15	187,5
126613	Soudaband ACRYL 300 10/3	Anthracite	3 mm	5 mm	12 mm	10 mm	10	30	300
126615	Soudaband ACRYL 300 15/3	Anthracite	3 mm	5 mm	12 mm	15 mm	10	20	200
126710	Soudaband ACRYL 300 20/3	Anthracite	3 mm	5 mm	12 mm	20 mm	10	15	150
126618	Soudaband ACRYL 300 10/4	Anthracite	4 mm	7 mm	16 mm	10 mm	8	30	240
126616	Soudaband ACRYL 300 15/4	Anthracite	4 mm	7 mm	16 mm	15 mm	8	20	160
126617	Soudaband ACRYL 300 20/4	Anthracite	4 mm	7 mm	16 mm	20 mm	8	15	120
126611	Soudaband ACRYL 300 15/6	Anthracite	6 mm	10 mm	24 mm	15 mm	5,6	20	112
126612	Soudaband ACRYL 300 20/6	Anthracite	6 mm	10 mm	24 mm	20 mm	5,6	15	84
126716	Soudaband ACRYL 300 30/6	Anthracite	6 mm	10 mm	24 mm	30 mm	5,6	10	56
126715	Soudaband ACRYL 300 20/8	Anthracite	8 mm	13 mm	32 mm	20 mm	4,3	15	64,5
152794	Soudaband ACRYL 300 30/8	Anthracite	8 mm	13 mm	32 mm	30 mm	4,3	10	43



MEMBRANES

Window tapes have been used for airtight sealing around windows and doors for years. The Soudal SWS window tape range consists of different versions: for internal and external use, with a self-adhesive strip and with or without a full surface self-adhesive backside. The intelligent Vario window tapes are the latest generation in window tapes. These tapes have a variable Sd value and can be used on both the inside and outside.

IN OUT

SWS VARIO EXTRA

Intelligent air- and driving raintight membrane with a variable Sd value



DESCRIPTION:

SWS Vario Extra is a moisture-controlling membrane with a 2 or 3-part split liner for the air- and watertight sealing of joints around windows, doors and panels. With its special properties the Sd value adapts to seasonal variations in temperature and air humidity. This enables the weather-independent transport of moisture from inside to outside or vice versa for an optimal drying effect of the joint the whole year round.



PROPERTIES:

- Airtight
- Driving rain tight (not suitable for primary water sealing)
- Variable Sd value
- Moisture regulating
- Pressure-sensitive, self-adhesive strip on one side for adhesion to the window frame and full surface adhering on the other side for adhesion to the building structure
- UV stability up to 12 months
- Suitable for plastering and pasting over

SWS INSIDE EXTRA

Airtight and vapour retardant window tape



DESCRIPTION:

SWS Inside Extra window tapes are flexible membranes, which allow for an airtight and vapour retardant sealing of interior connections around windows, doors and panels. On top of the high quality self-adhesive strip on the print side, for adhesion to the window frame, the SWS Inside Extra is also equipped with a full-surface self-adhesive back side. So no additional adhesive is required.



PROPERTIES:

- Airtight
- Vapour barrier: Sd > 47 m
- Flexible and tear resistant
- Pressure sensitive self-adhesive strip for adhesion to the window frame
- Pressure sensitive full-surface self-adhesive back side for adhesion to the wall with 2- or 3-way split liner
- For indoor applications
- Can be plastered and bonded on

IN

SWS OUTSIDE EXTRA

Air- and driving rain tight and vapour open window tape



DESCRIPTION:

SWS Outside Extra window tapes are flexible membranes, which allow for a vapour open, air-, driving rain tight sealing of exterior connections around windows, doors and panels. On top of the high quality self-adhesive strip on the print side, for adhesion to the window frame, the SWS Outside Extra is also equipped with a full-surface self-adhesive back side. So no additional adhesive is required.



PROPERTIES:

- Air-, driving rain and wind tight
- Vapour permeable: Sd ≤ 0,72 m
- 9 months UV resistant
- Flexible and tear resistant
- Pressure sensitive self-adhesive strip for adhesion to the window frame
- Pressure sensitive full-surface self-adhesive back side for adhesion to the wall with 2- or 3-way split liner
- For outdoor applications
- Can be plastered and bonded on

OUT

MEMBRANES

IN

SWS INSIDE STANDARD

Airtight and vapour retardant window tape



DESCRIPTION:

SWS Inside Standard window tapes are flexible membranes, which allow for an airtight and vapour retardant sealing of interior connections around windows, doors and panels. The SWS Inside Standard is equipped with a high quality self-adhesive strip and release liner on the print side for adhesion to the window frame. To permanently bond the SWS Inside Standard window tape to the wall, always use Soudafoil 330D or 360H.



PROPERTIES:

- Airtight
- Vapour barrier: $S_d > 47 \text{ m}$
- Flexible and tear resistant
- Pressure sensitive self-adhesive strip for adhesion to the window frame
- For indoor applications
- Can be plastered and bonded on

OUT

SWS OUTSIDE STANDARD

Air- and driving rain tight and vapour open window tape



DESCRIPTION:

SWS Outside Standard window tapes are flexible membranes, which allow for a vapour open, air-, driving rain tight sealing of exterior connections around windows, doors and panels. The SWS Outside Standard is equipped with a high quality self-adhesive strip and release liner on the print side for adhesion to the window frame. To permanently bond the SWS Outside Standard window tape to the wall, always use Soudafoil 360H.



PROPERTIES:

- Air-, driving rain and wind tight
- Vapour permeable: Standard: $S_d \leq 0,06 \text{ m}$
- UV resistant
- Flexible and tear resistant
- Pressure sensitive self-adhesive strip for adhesion to the window frame
- For outdoor applications
- Can be plastered and bonded on

IN

OUT

SOUDAFOIL 360H

Elastic sealant and adhesive for bonding all SWS window tapes



DESCRIPTION:

Airtight, elastic, hybrid polymer based sealant and adhesive for full surface bonding of SWS Inside and SWS Outside Standard tapes to the building envelope. Does not contain isocyanates or solvents. Soudafoil 360H complies with DIN 4108-7 and is part of the Soudal Window System.



PROPERTIES:

- Easy to tool, extrude (even at low temperatures) and finish in all weather conditions
- For interior and exterior use
- Stays elastic after curing and very sustainable
- UV resistant, waterproof and resistant to weathering
- Very high adhesive strength (without primer) on most common building materials even on damp surfaces

IN

SOUDAFOIL 330D

Plasto-elastic sealant and adhesive for bonding SWS Inside window tapes



DESCRIPTION:

Airtight plasto-elastic sealant and adhesive based on acrylic dispersion for bonding SWS Inside Standard tapes. Only for interior use. Soudafoil 330D complies with DIN 4108-7.

PROPERTIES:

- Easy to tool
- For interior and use only
- Low water vapour permeability
- Colour stable and waterproof after curing
- Very good adhesion on many porous materials and aluminium
- Free of solvents and silicones

MEMBRANES



EPDM MEMBRANE

IN OUT

Air- and watertight EPDM based façade membrane

DESCRIPTION:

Soudal EPDM Membrane is a very tear-resistant, elastic and bitumen compatible air-and watertight membrane made of EPDM rubber

PROPERTIES:

- Air- and watertight
- Compatible with bitumen
- Good temperature resistance
- Good weather and UV resistance
- Resistant against alkali micro-organisms
- Stays elastic
- Flexible
- High tear resistance
- Complies with EN13984



EPDM MEMBRANE FIX

IN OUT

EPDM membrane fix

DESCRIPTION:

Soudal EPDM Membrane Fix is a very tear-resistant, elastic and bitumen compatible air-and watertight membrane made of EPDM rubber. Soudal EPDM Membrane Fix contains a self-adhesive butyl strip for direct adhesion to the facade element.

PROPERTIES:

- Air- and watertight
- Adhesive strip (= time-saving mounting)
- Compatible with bitumen
- Good temperature resistance
- Good weather and UV resistance
- Resistant against alkali
- Stays elastic
- Flexible
- High tear resistance
- Complies with EN13984



SILIRUB EPDM

IN OUT

CE-marked sealant compatible for all Soudal EPDM membranes

DESCRIPTION:

Silirub EPDM is a high-quality, neutral, elastic one-component joint sealant based on fast skinning silicones.

PROPERTIES:

- Very easy to apply
- Colourfast and UV resistant
- Permanently elastic after curing
- Very good adhesion on many materials
- Low modulus
- Especially developed for EPDM applications
- MEKO free



SODASEAL EPDM

IN OUT

Adhesive compatible for all Soudal EPDM membranes

DESCRIPTION:

Soudaseal EPDM is a high quality, neutral, elastic, 1-component Hybrid polymer based adhesive sealant for bonding and sealing of Soudal EPDM membranes in interior and exterior applications.

PROPERTIES:

- Very good adhesion to Soudal EPDM membranes
- Good adhesion on most common building materials.
- Primerless adhesion even on damp surfaces due to unique adhesion promoters.
- Easy to tool, extrude (even at low temperatures) and finish in all weather conditions.
- Stays elastic after curing and very durable
- Solvent, halogen, acid and isocyanate free
- UV resistant, waterproof and resistant to weathering



SEALANTS

Joints can have different purposes. Elastic sealants are an important part of the building envelope where the different parts move separately in relation to each other. As a leading expert in sealants, Soudal can always offer the right product for each specific application. All our products always satisfy the most stringent standards, so you can rely on the quality of our sealants for years on end.



ACRYRUB SWS

IN

Elastic silanised acrylic joint sealant conform DIN EN ISO 116000 F 12,5 E

DESCRIPTION:

Plastering up to the window frame will cause small tears and debonding after only a short time, which will have a negative impact on the airtightness. To avoid this, it is best to use a paintable sealant with sufficient movement capability. Acryrub SWS was developed especially for this application, about the only acrylic sealant meeting the class 12,5 E requirements (CE marking F-EXT-INT-12.5E).

PROPERTIES:

- Airtight
- Permanently elastic after curing
- Colour stable and waterproof
- Very good adhesion on many porous substrates, hard PVC and aluminium
- Can be painted over after curing



SOUDASEAL 215 LM

IN OUT

Neutral cure, elastic MS-Polymer[®] based joint sealant

DESCRIPTION:

ATG approved facade sealant based on MS polymer[®]. This high quality sealant has a large movement capability (class F-EXT-INT-CC- 25LM in accordance with the new CE marking). Particularly suitable as a long-term sealant for expansion joints exposed to all weather conditions. Ideal for sealing joints between exterior joinery and the outer cavity wall leaf, even for natural stone (threshold).

PROPERTIES :

- Permanently elastic after curing
- Tested to and in accordance with ISO 11600 F-25LM
- Easy to tool, extrude (even at low temperatures) and finish in all weather conditions
- Good weather and UV resistance
- Broad bonding spectrum on porous and non-porous materials, even on slightly wet substrates
- No staining effect on natural stone



SILIRUB PRO N

IN OUT

Premium neutral cure, elastic silicone based joint sealant

DESCRIPTION:

For the professional sealing of expansion and connection joints with extreme continuous load throughout the construction sector, such as outdoor vapour open connection joints between masonry and windows and doors according to EnEV DIN 4108 and RAL installation guidelines. Complies with DIN 18545 Part 2, E / ISO 11600-F-25LM.

PROPERTIES:

- Permanently elastic after curing
- UV resistant
- Long open time
- Excellent moisture and mold resistance
- Very good adhesion on many materials



SEALANTS



SILIRUB WS

IN OUT

Neutral cure, elastic silicone for dilatation joints in curtain walls

DESCRIPTION:

Silirub WS is a high-quality, neutral, elasticone-component joint sealant based on fast skinning silicones. Silirub WS has been developed for weather sealing of expansion joints in the façade industry.

PROPERTIES:

- Compatible with PVB-film
- Compatible with sealants for double glazing
- Permanently elastic after curing
- Neutral curing
- Resistant against UV-radiation, rain, frost, wind, ozone and extreme temperatures
- Excellent adhesion properties on glass (laminated), coated aluminium, galvanised steel, concrete and masonry
- Very good resistance to ageing
- Not suitable for natural stone
- MEKO free



SILIRUB MA

IN OUT

High-quality, neutral, elastic silicone based joint sealant for natural stones

DESCRIPTION:

Silirub MA is a natural stone neutral cure silicone sealant for the sealing of marble and all other types of natural stone. Will not stain joint surfaces, therefore especially suited for all applications on natural stone. Available in clear and natural stone colours.

PROPERTIES:

- No staining on natural stone and other porous surfaces
- Very easy to apply
- UV resistant
- Impervious to mould, contains ZnP (biocide with fungicidal action)
- Permanently elastic after curing
- Very good adhesion on many materials
- Low modulus
- MEKO free



SILIRUB 2

IN OUT

Top-grade, neutral cure silicone for a wide range of applications

DESCRIPTION:

ATG approved for use in facade and glazing joints. Very large movement capability (class F-EXT-INT-CC- 25LM and G-CC-25LM in accordance with the new CE marking - harmonised standard EN15651 or 25 F/G in accordance with the EN ISO11600 standard). Ideal as a sealant between exterior joinery and the exterior cavity wall leaf (not suitable for natural stone) or for glazing applications. Available in many colours.

PROPERTIES:

- Permanently elastic after curing
- Test and in accordance with ISO 11600 F&G 25 LM
- 100% silicone, no shrinkage
- Colour stable and UV resistant
- Very good adhesion on many materials



SILIRUB COLOR

IN OUT

Top-grade, neutral cure silicone based sealant using the RAL® colour system

DESCRIPTION:

Neutral silicone sealant, of high quality. Bonds on most building substrates. Permanent elasticity unalterable colour and resistant to UV radiation. Available in the most common colours used for windows.

PROPERTIES:

- Available in all RAL Classic System colours
- Permanently elastic after curing
- Conforms to ISO 11600 F&G 25 LM
- 100% silicone, no shrinkage
- Colour stable and UV resistant
- Very good adhesion on many materials



ACCESSORIES

To facilitate the application of SWS products during the installation of windows and doors up to the cleaning, Soudal offers a range of accessories selected by our experts. The right tools is half the job!



GUN & FOAM CLEANER

Cleaning aerosol for uncured PU foams

DESCRIPTION:

To remove residual polyurethane foam that has not yet cured on all non-porous surfaces. Ideal for cleaning the inside and outside of guns and other tools. Filled with harmless HCFC- and CFC-free propellants.



CLICK & CLEAN

Cleaning aerosol for uncured PU foams

DESCRIPTION:

To remove residual polyurethane foam that has not yet cured on all non-porous surfaces. Ideal for cleaning the inside and outside of guns and other tools. Filled with harmless HCFC- and CFC-free propellants. For use with patented Click & Fix system.



COMPACT FOAM GUN

Lightweight, compact foam applicator

DESCRIPTION:

The Soudal Compact Foam Gun is an high quality, easy to clean, lightweight foam applicator tool with precise, adjustable dosing properties. Available with standard screw connection or Click&Fix.



PROFI GUN (CLICK & FIX)

Heavy Duty PU foam applicator

DESCRIPTION:

The Soudal profi (Click & Fix) Foam Gun is a professional, heavy duty, foam applicator tool with precise, adjustable dosing properties. Available with standard screw connection or the patented Click & Fix system.

ACCESSORIES



SWIPEX
Extra big size cleaning wipes

DESCRIPTION:
Dissolves fresh und uncured adhesive and sealant remains (silicone, hybrid polymer, PU, acryl...) as well as PU-foam, paint etc on all non-porous substrates. Can also be used to clean uncured remains and dirt from hands and tools, dermatologically safe to use.



SURFACE CLEANER
Universal cleaner

DESCRIPTION:
Surface Cleaner is a universal solvent cleaner designed for use prior to the application of Soudal window fabrication products. It can also be used for the removal of excess Aluseal, PU, silicone and hybrid polymers.



SILICONE REMOVER
Ready-to-use and fast-working

DESCRIPTION:
Silicone Remover is a ready-to-use and fast-working product based on hydrocarbons for removing hardened silicones and MS polymers.



PU-REMOVER
Cleaning kit for cured PU foam

DESCRIPTION:
Fast and highly effective remover for hardened PU foam residues on all non-porous surfaces.



PROFESSIONAL CAULKING GUN
Heavy duty skeleton cartridge gun

DESCRIPTION:
Professional grade, metal skeleton caulk gun for standard cartridges up to 310 ml. High performance, strong and durable. The cartridge dispenser is features a high trust ratio for a smooth extrusion, even for high viscous products, and a dripless system, to prevent excess caulk leakage.



FOILPACK CAULKING GUN
Top-grade manual caulk gun for foil packs up to 600 ml

DESCRIPTION:
Its durable design is perfect for frequent high volume use and features an easy to clean aluminum barrel. This caulk gun also features an instant pressure release tab, to prevent excess caulk leakage.

ACCESSORIES



SWS SPRAY PRIMER

Universal adhesion promoter

DESCRIPTION:

Universal adhesion promoter for substrates and applications on which self-adhesive products (tapes, membranes and pre-compressed joint sealing tapes) have a poorer adhesion. Ready-to-use in aerosol packaging. Improves the adhesion of self-adhesive window tapes on porous and non-porous substrates, even at slightly negative temperatures (max -10°C).



PRIMER 300

Primer for hybrid based membranes on bituminous substrates

DESCRIPTION:

Primer 300 is a transparent, water-based primer with high sealing capacity, that enhances the compatibility of hybrid-based membranes with bituminous substrates. Prevents possible discolouration.



SOUDABAND STRAP

Strap for joint sealing tapes

DESCRIPTION:

The Soudaband Strap is an aid to keep wider joint sealing tapes (≥ 50 mm), such as Soudaband PRO MF1 from decompressing after usage. The Soudaband strap can be fastened and tightened around the leftover tape to keep it from decompressing. Prevents waste and helps with storage.



SOUDABAND CLIP

Clip for joint sealing tapes

DESCRIPTION:

The Soudaband Clip is an aid to keep smaller joint sealing tapes (≤ 30 mm), such as Soudaband PRO BG-1 and Acryl 300 from decompressing after usage. The Soudaband Clip can be secured onto the leftover roll. Prevents waste and helps with storage.

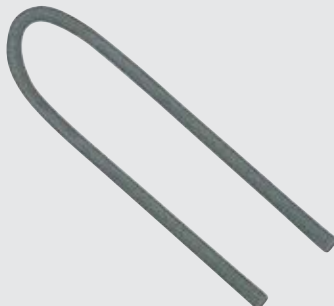

PE-PU BACKER ROD

Ready-to-use and fast-working

DESCRIPTION:

Soudal backer rods are round in profile and made from closed-cell PE or open-cell PU foam. The backer rods are used as non-adhesive backfilling in construction joints and to ensure correct joint dimensions for sealants. Supplied in 1 m lengths.



WINBAG

Air Wedge levelling tool

DESCRIPTION:

Powerful hand operated inflatable air cushion for levelling and fixing. Load-bearing capacity 135 kg per Winbag. Joint width 2-50 mm. Fibre reinforced material. With the WINBAG, a single professional installer can position, adjust, align, level and hold work materials in place, saving time and reducing costs.

PRODUCT OVERVIEW

SEALANTS

Art. nr.	Description
112501	300 ML SILIRUB EPDM
112130	600 ML SILIRUB EPDM
130549	600 ML SOUDASEAL EPDM
*	SOUDAEAL 215LM
*	SILIRUB PRO N
*	ACRYRUB SWS
*	SILIRUB WS
*	FIX ALL HIGH TACK
*	SILIRUB 2
*	SILIRUB COLOR
*	SOUDASEAL MA

*Contact your local Soudal dealer

ACCESSORIES

Art. nr.	Description
123001	GUN & FOAM CLEANER
113432	CLICK & CLEAN
115778	PU-REMOVER
102853	SILICONE REMOVER
128470	SWIPEX CLEANING WIPES (50 PCS)
154478	PROFI FOAM GUN
154480	PROFI FOAM GUN CLICK&FIX
109953	SOUDAL COMPACT FOAM GUN
110226	SOUDAL COMPACT FOAM GUN CLICK&FIX
106617	PROFESSIONAL CARTRIDGE CAULKING GUN
106515	PROFESSIONAL FOIL PACK CAULKING GUN
110307	6MM PE BACKER ROD GREY
110308	10MM PE BACKER ROD GREY
110309	13MM PE BACKER ROD GREY
110310	15MM PE BACKER ROD GREY
106783	20MM PE BACKER ROD GREY
110422	25MM PE BACKER ROD GREY
110423	30MM PE BACKER ROD GREY
110283	15MM PU BACKER ROD BLACK
110284	20MM PU BACKER ROD BLACK
110285	25MM PU BACKER ROD BLACK
110286	30MM PU BACKER ROD BLACK
110287	40MM PU BACKER ROD BLACK
110288	50MM PU BACKER ROD BLACK
124490	SOUDAL WINBAG SET (4 PCS)
156498	SWS SPRAY PRIMER
156215	SOUDABAND STRAP
154832	SOUDABAND CLIP
158830	PRIMER 300
107789	SURFACE CLEANER 500 ML

FOAMS

Art. nr.	Description
117472	750 ML FLEXIFOAM GUN
118318	750 ML FLEXIFOAM CLICK & FIX
157325	FLEXIFOAM X-TRA CLICK & FIX
158835	FLEXIFOAM X-TRA CLICK & FIX COMBI BOX

LIQUID MEMBRANES

Art. nr.	Description
154260	600 ML SOUDATIGHT LQ BLACK
146281	600 ML SOUDATIGHT LQ WHITE
145785	4,5 KG SOUDATIGHT LQ BLACK
145788	4,5 KG SOUDATIGHT LQ WHITE
156468	600 ML SOUDATIGHT SP WHITE
156469	600 ML SOUDATIGHT SP BLACK
145787	11 KG SOUDATIGHT SP BLACK
145789	11 KG SOUDATIGHT SP WHITE
134739	16 KG SOUDATIGHT SP BLACK
130545	600 ML SOUDATIGHT HYBRID GREY
145786	6 KG SOUDATIGHT HYBRID GREY
131003	SOUDATEXILE 15 CM X 20 M
131896	10 SETS OF NOZZLES FOR COX JETFLOW
131824	COX JETFLOW 3 FOIL BAG
155294	5 KG SOUDATIGHT WP
155295	10 KG SOUDATIGHT WP
156107	FOIL BAG ADAPTER S15
156108	30 MM FLAT BEAD NOZZLE (S15)
156109	20 MM FLAT BEAD NOZZLE (S15)

MEMBRANES

Art. nr.	Description
145962	SWS INSIDE STANDARD 70 MM
145961	SWS INSIDE STANDARD 100 MM
145963	SWS INSIDE STANDARD 150 MM
153508	SWS INSIDE STANDARD 200 MM
153507	SWS INSIDE STANDARD 250 MM
153506	SWS INSIDE STANDARD 300 MM
145960	SWS OUTSIDE STANDARD 70 MM
145965	SWS OUTSIDE STANDARD 100 MM
145959	SWS OUTSIDE STANDARD 150 MM
153505	SWS OUTSIDE STANDARD 200 MM
153504	SWS OUTSIDE STANDARD 250 MM
153503	SWS OUTSIDE STANDARD 300 MM
145964	SWS INSIDE EXTRA 70 MM
145958	SWS INSIDE EXTRA 100 MM
145967	SWS INSIDE EXTRA 150 MM
155283	SWS INSIDE EXTRA 200 MM
155284	SWS INSIDE EXTRA 250 MM
155285	SWS INSIDE EXTRA 300 MM
145957	SWS OUTSIDE EXTRA 70 MM
145966	SWS OUTSIDE EXTRA 100 MM
145968	SWS OUTSIDE EXTRA 150 MM
155287	SWS OUTSIDE EXTRA 200 MM
155288	SWS OUTSIDE EXTRA 250 MM
155289	SWS OUTSIDE EXTRA 300 MM
157711	SWS VARIO EXTRA 70 MM
157712	SWS VARIO EXTRA 100 MM
157713	SWS VARIO EXTRA 150 MM
157714	SWS VARIO EXTRA 200 MM
157725	SWS VARIO EXTRA 250 MM
157726	SWS VARIO EXTRA 300 MM
120157	600 ML SOUDAF0IL 360H
120158	600 ML SOUDAF0IL 330D
130283	SOUDAL EPDM MEMBRANE FIX 0,8X150MM/20M
130284	SOUDAL EPDM MEMBRANE FIX 0,8X200MM/20M
130285	SOUDAL EPDM MEMBRANE FIX 0,8X250MM/20M
130286	SOUDAL EPDM MEMBRANE FIX 0,8X300MM/20M
130287	SOUDAL EPDM MEMBRANE 1,2X200MM/20M
130288	SOUDAL EPDM MEMBRANE 1,2X250MM/20M
130289	SOUDAL EPDM MEMBRANE 1,2X300MM/20M
130290	SOUDAL EPDM MEMBRANE 1,2X400MM/20M

TECHNICAL DRAWINGS

TUNNEL INSTALLATION

BASIC

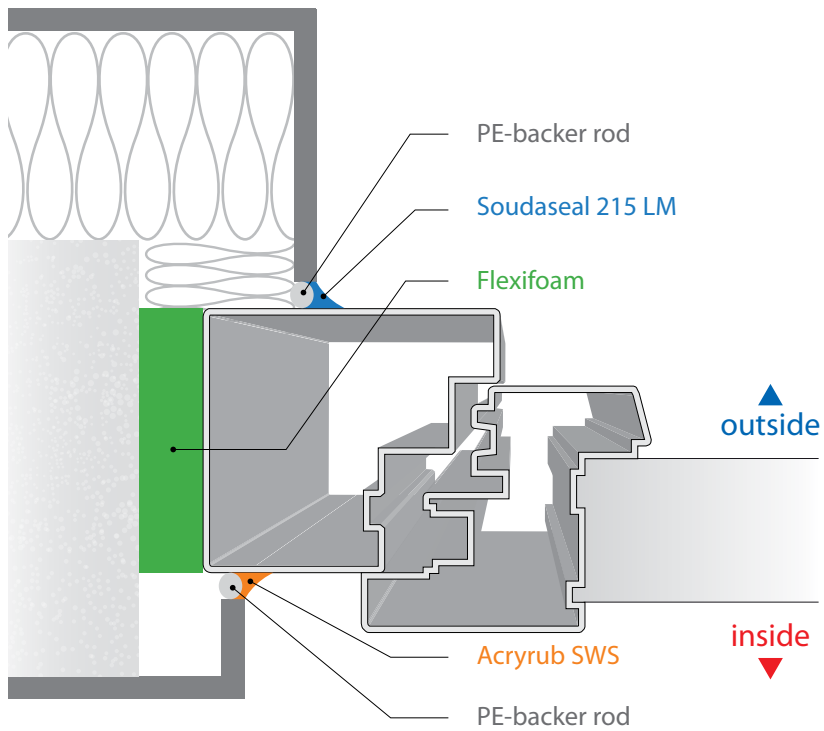

BASIC



PLUS

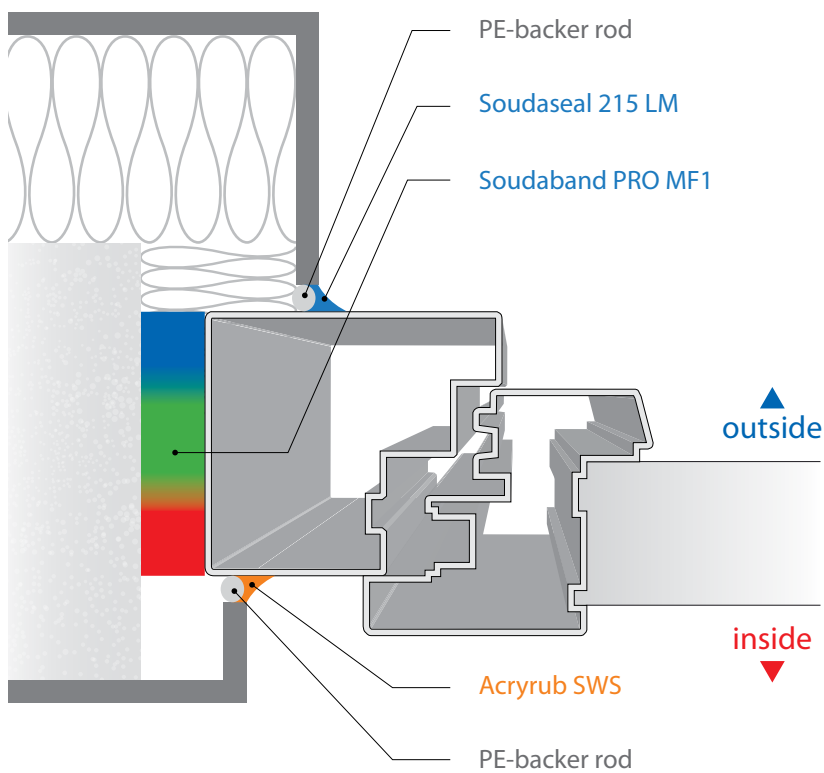

PLUS



TUNNEL INSTALLATION

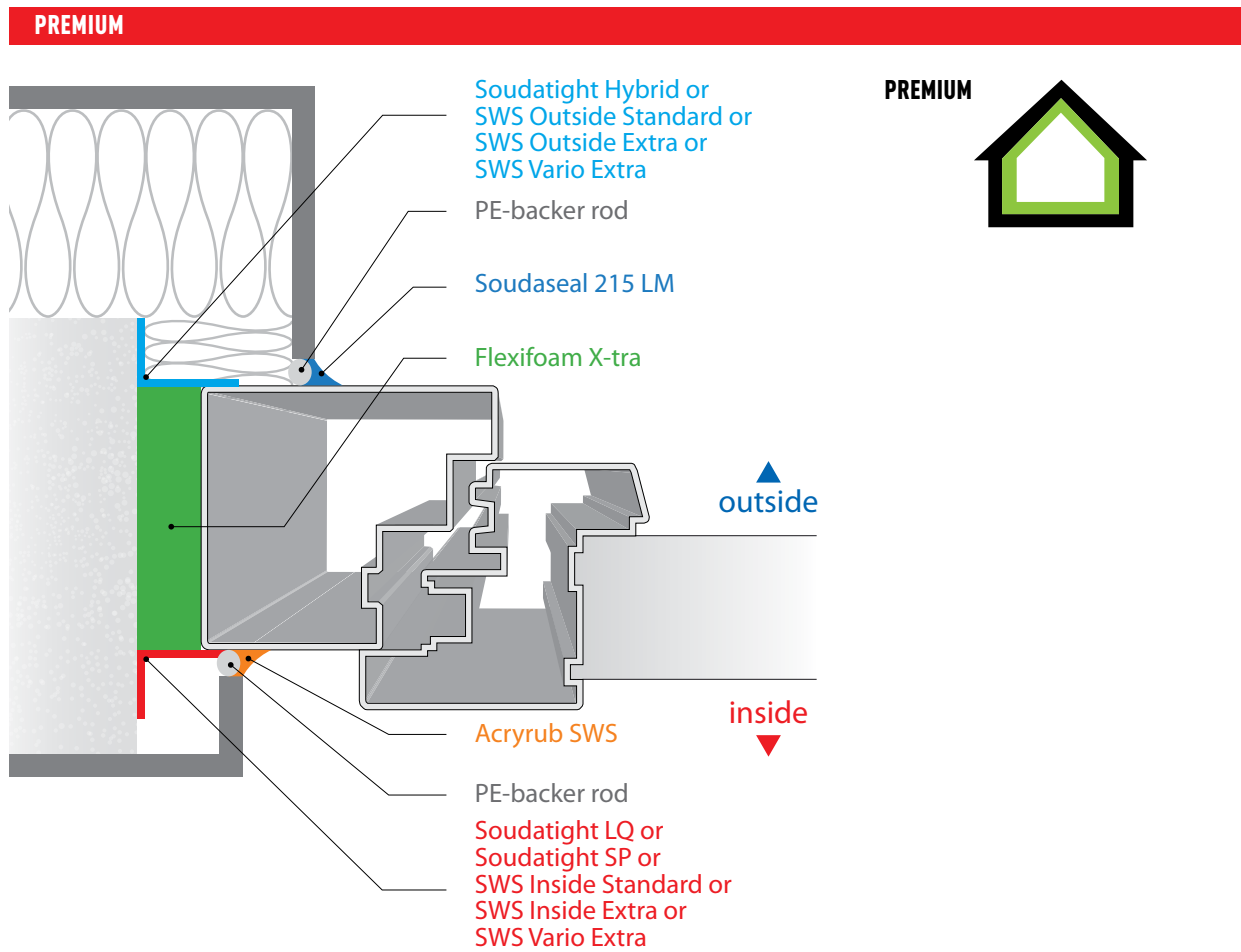

Product overview

	OUTSIDE	MIDDLE	INSIDE
BASIC 	<ul style="list-style-type: none"> Soudaseal 215LM or Soudaseal 225 or Silitrub PRO N or Silitrub 2 or Silitrub Color 	<ul style="list-style-type: none"> Flexifoam Soudaband PRO MF1 	<ul style="list-style-type: none"> Acryrub SWS
PLUS 	<ul style="list-style-type: none"> Soudaseal 215LM or Soudaseal 225 or Silitrub PRO N or Silitrub 2 or Silitrub Color 	<ul style="list-style-type: none"> Flexifoam Soudaband PRO MF1 	<ul style="list-style-type: none"> Acryrub SWS
PREMIUM 	<ul style="list-style-type: none"> Soudatight Hybrid or SWS Outside Standard or SWS Outside Extra or SWS Vario Extra Soudaseal 215 LM or Soudaseal 225 or Silitrub PRO N or Silitrub 2 or Silitrub Color 	<ul style="list-style-type: none"> Flexifoam Flexifoam X-tra 	<ul style="list-style-type: none"> Acryrub SWS Soudatight LQ or Soudatight SP (GUN) or SWS Inside Standard or SWS Inside Extra or SWS Vario Extra

CAVITY WALL INSTALLATION

BASIC

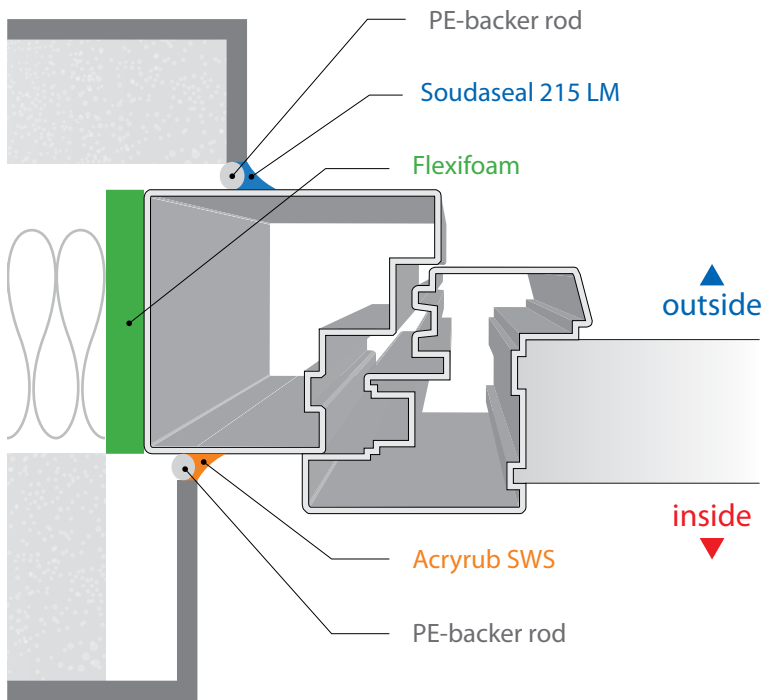

BASIC



PLUS

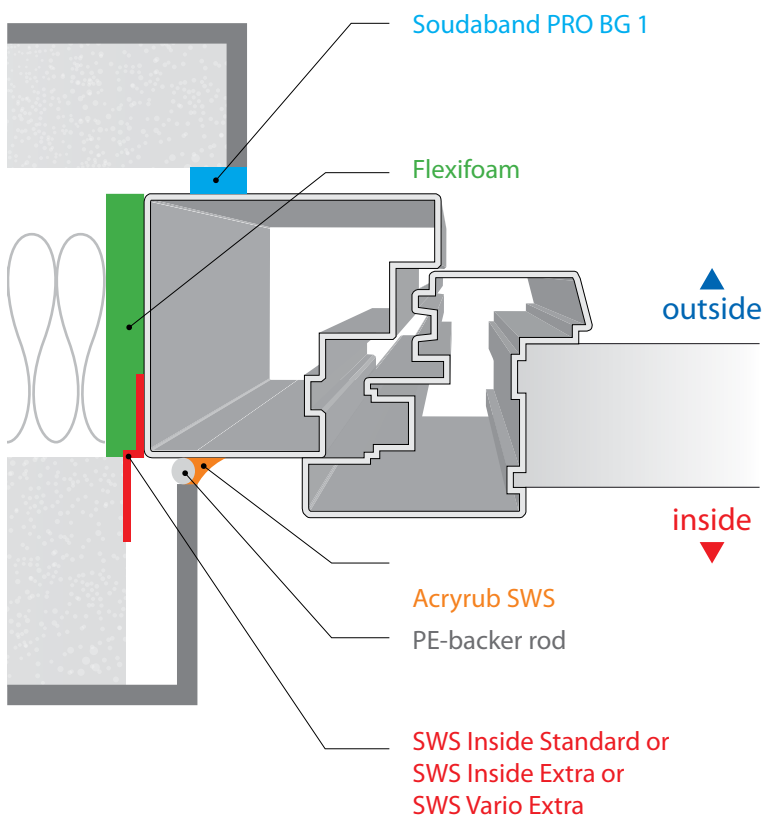

PLUS



CAVITY WALL INSTALLATION

PREMIUM

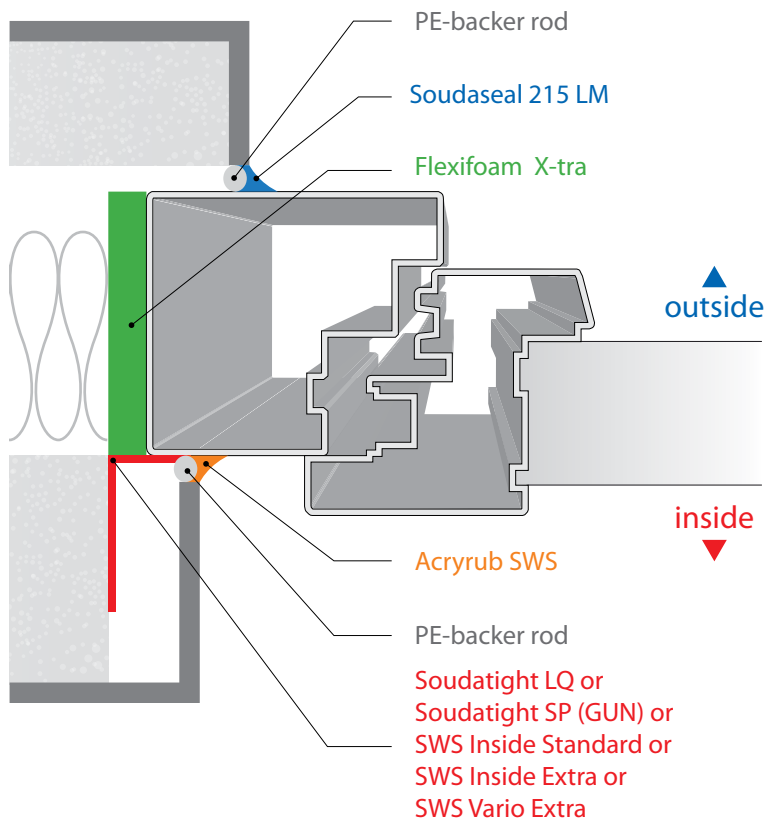

PREMIUM



Product overview

	OUTSIDE	MIDDLE	INSIDE
BASIC 	<ul style="list-style-type: none"> Soudaseal 215LM or Soudaseal 225 or Silitrub PRO N or Silitrub 2 or Silitrub Color 	<ul style="list-style-type: none"> Flexifoam 	<ul style="list-style-type: none"> Acryrub SWS
PLUS 	<ul style="list-style-type: none"> Soudaseal 215 LM or Soudaseal 225 or Silitrub PRO N or Silitrub 2 or Silitrub Color Soudaband PRO BG-1 	<ul style="list-style-type: none"> Flexifoam 	<ul style="list-style-type: none"> Acryrub SWS
PREMIUM 	<ul style="list-style-type: none"> Soudaseal 215LM or Soudaseal 225 or Silitrub PRO N or Silitrub 2 or Silitrub Color 	<ul style="list-style-type: none"> Flexifoam Flexifoam X-tra 	<ul style="list-style-type: none"> Acryrub SWS Soudatight LQ or Soudatight SP (GUN) or SWS Inside Standard or SWS Inside Extra or SWS Vario Extra



SOU^{SWI}DAFRAME

SOU^{SWI}DAL

SOU^{SWI}DAFRAME

SOU^{SWI}DAL

SOUDAFRAME SWI

EASY, QUICK & SAFE

WINDOW INSTALLATION MADE EASY!



SYSTEM COMPONENTS

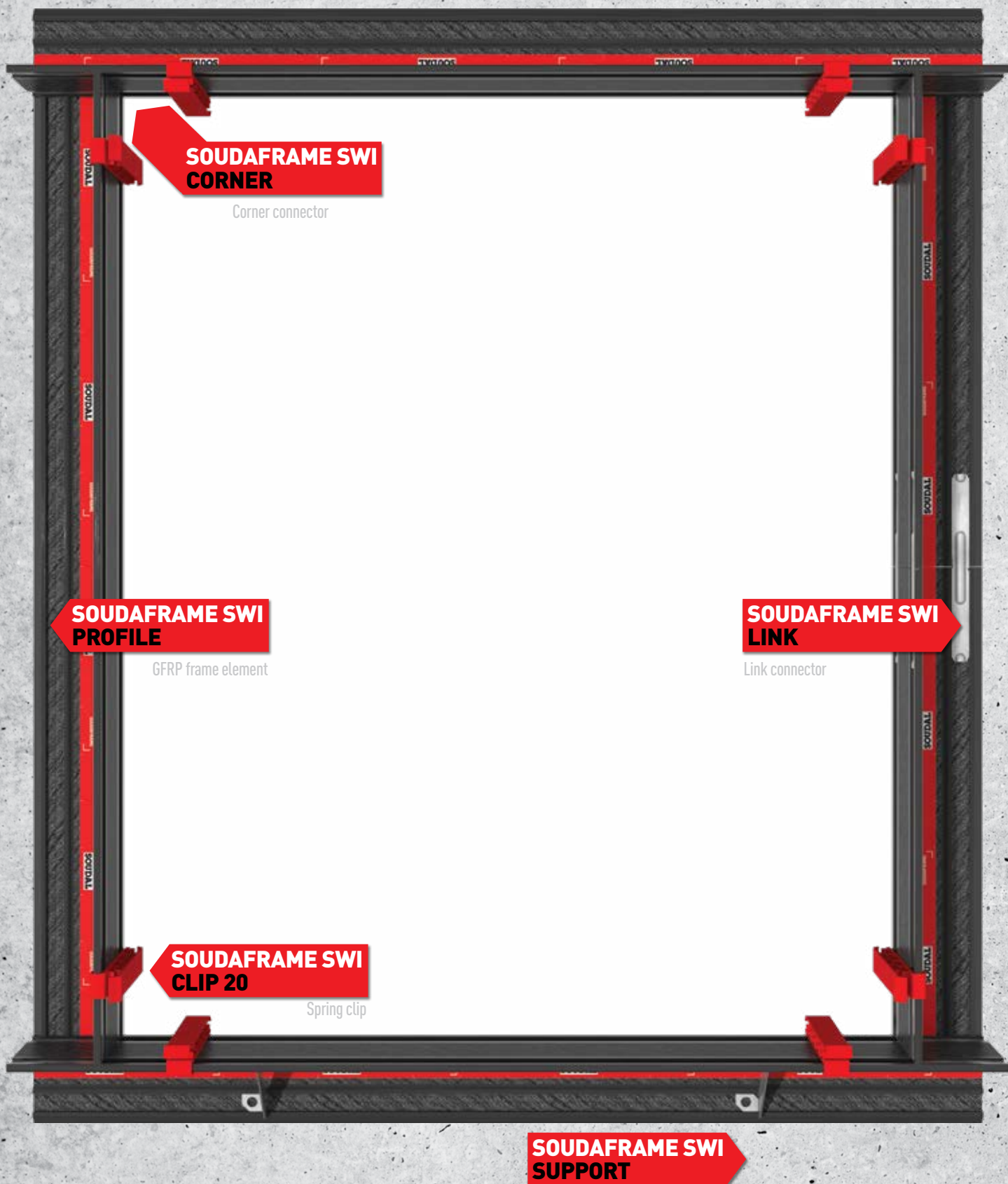

SYSTEM COMPONENTS



SOUDAFRAME SWI CORNER

High-quality metal connection piece for an easy, safe and error-free connection of the frame elements. The innovative plug-in solution enables a fast installation and high flexibility on the construction site.



SOUDAFRAME SWI LINK

Connector for extending frame elements at e.g. large windows, use of cut-off frame elements.



SOUDAFRAME SWI SUPPORT

Support bracket for increased load transfer for large and heavy windows as well as for sliding doors.



SOUDAFRAME SWI CLIP 20

Practical installation aid for an automatic fixation and easy alignment of the window frame in the sub-frame. The pressure of the spring clip holds the frame into place and allows easy adjustment by hand. No more hassle with looking for the right size wedge.



SOUDAFRAME SWI HYBRID

Elastic, one-component adhesive and sealant based on hybrid polymer with a very high initial tack. Soudaseal SWI was specially developed for bonding and air- and watertight sealing of the SoudaFrame SWI pre-wall window installation system.

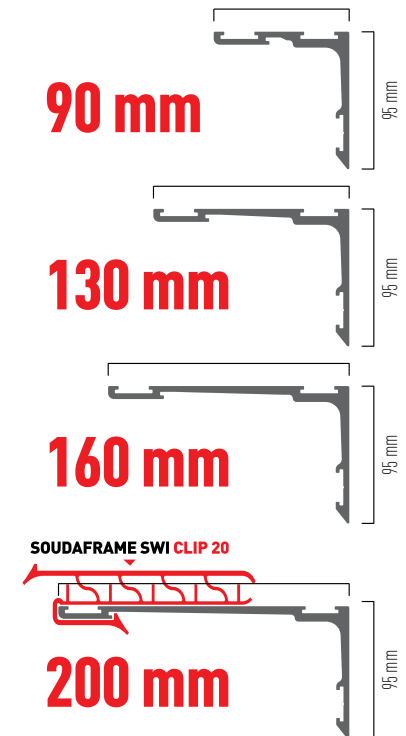

SODAL NV
EVERDONGENLAAN 18-20
B-2300 TURNHOUT
TEL.: +32 (0)14 42 42 31
FAX: +32 (0)14 42 65 14
EMAIL: SALES@SODAL.COM
WWW.SODAL.COM

YOUR DISTRIBUTOR

